

T0014

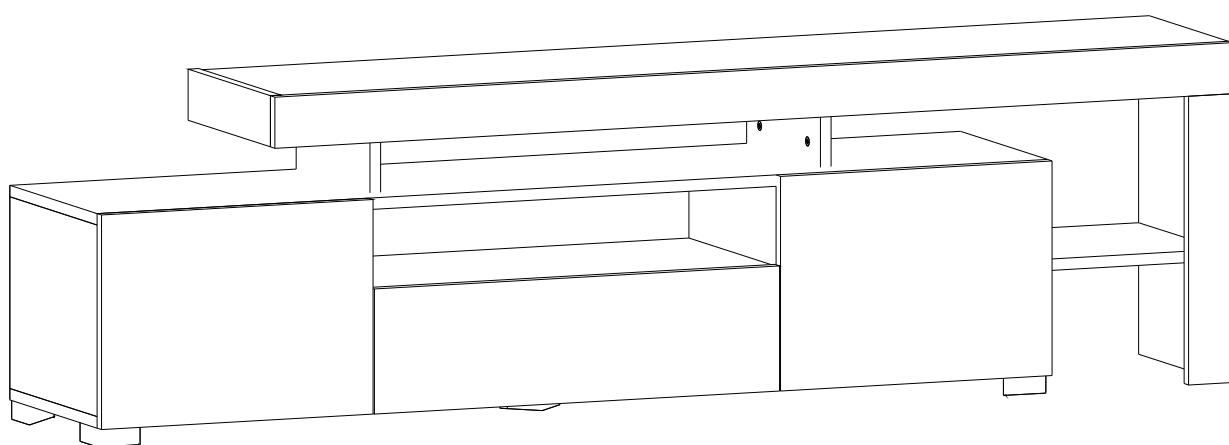
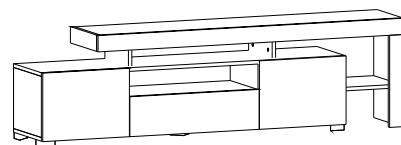

Dear Customer,

We design and produce our products for people to love and have fun with them as we do.

The product you bought was subjected to all sorts of tests and control before sending out to you.



Before start assembling, please check the whole components and accessories according to the lists. If you bought more than one product, to prevent confusion be sure that you completed the first product. Then start the other product's assembling.



Before start assembling, please clean all the components with a damp cloth. Also for usual cleaning, this will be enough.



Although all the products are produced and packed carefully, sometimes happen that some component is damaged during the transportation. In such a case please check the missing or damaged part and do not hesitate to contact us. You can send e-mail to info@inarchdizayn.com or reach us at 0541 353 1700

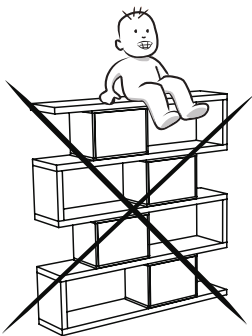

Do not use your furniture for out of purposes. If you would like to use it, please contact us for further questions.







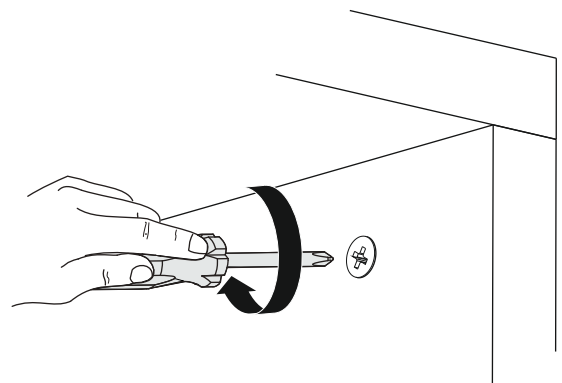
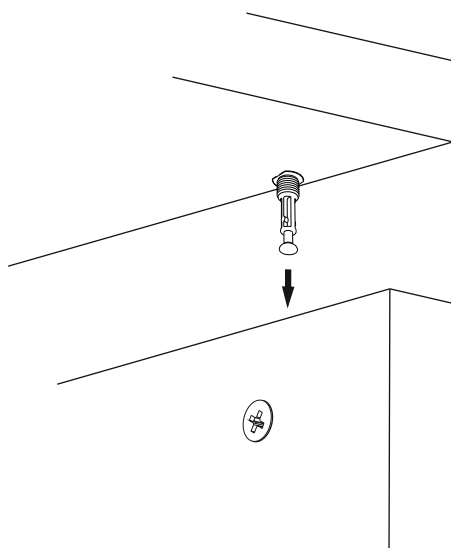
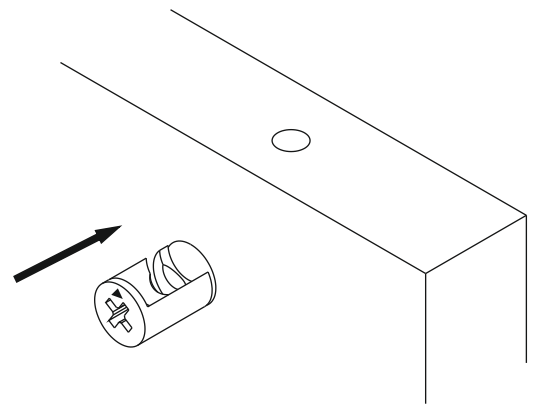
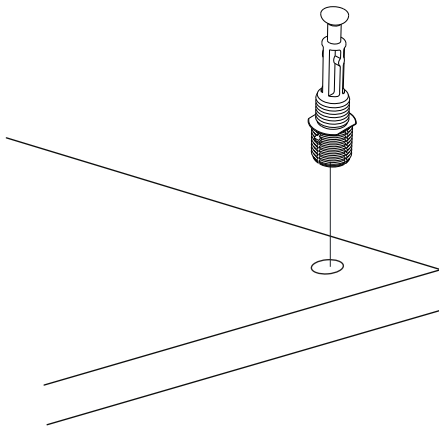
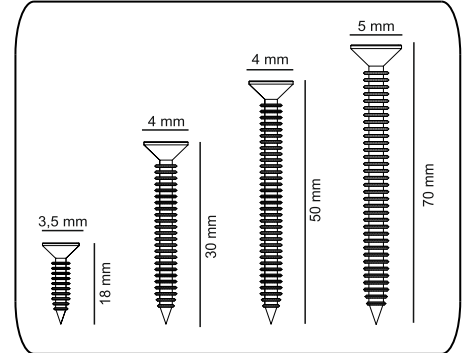
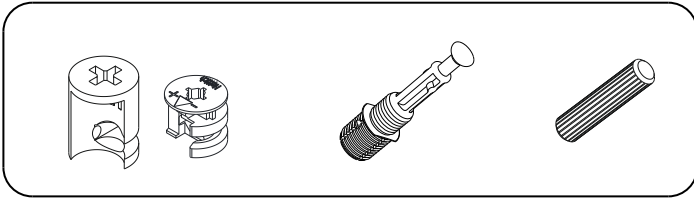

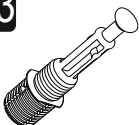

Do not directly contact your furniture with excessive heat, cold and humidity because the product can be affected..

ATTENTION !!

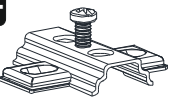
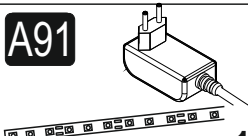
Minifix is the main connection material used in products. Before starting assembly, please check the drawings below.

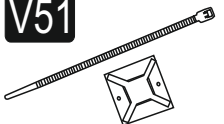

ACCESSORY LIST

A23  Minifix M8 40x	A22  Minifix G18 40x	A04  KVLY 31x	C01  DM 6x	C04  MA 6x
A91  1x	A57  30mm 5x	A34  3,5x25 15x	A18  3,5x18 24x	A48  AC 20x
		A17  4x50 4x	A06  18 mm 44x RNK1	V51  CRT 3x

GENERAL VIEW

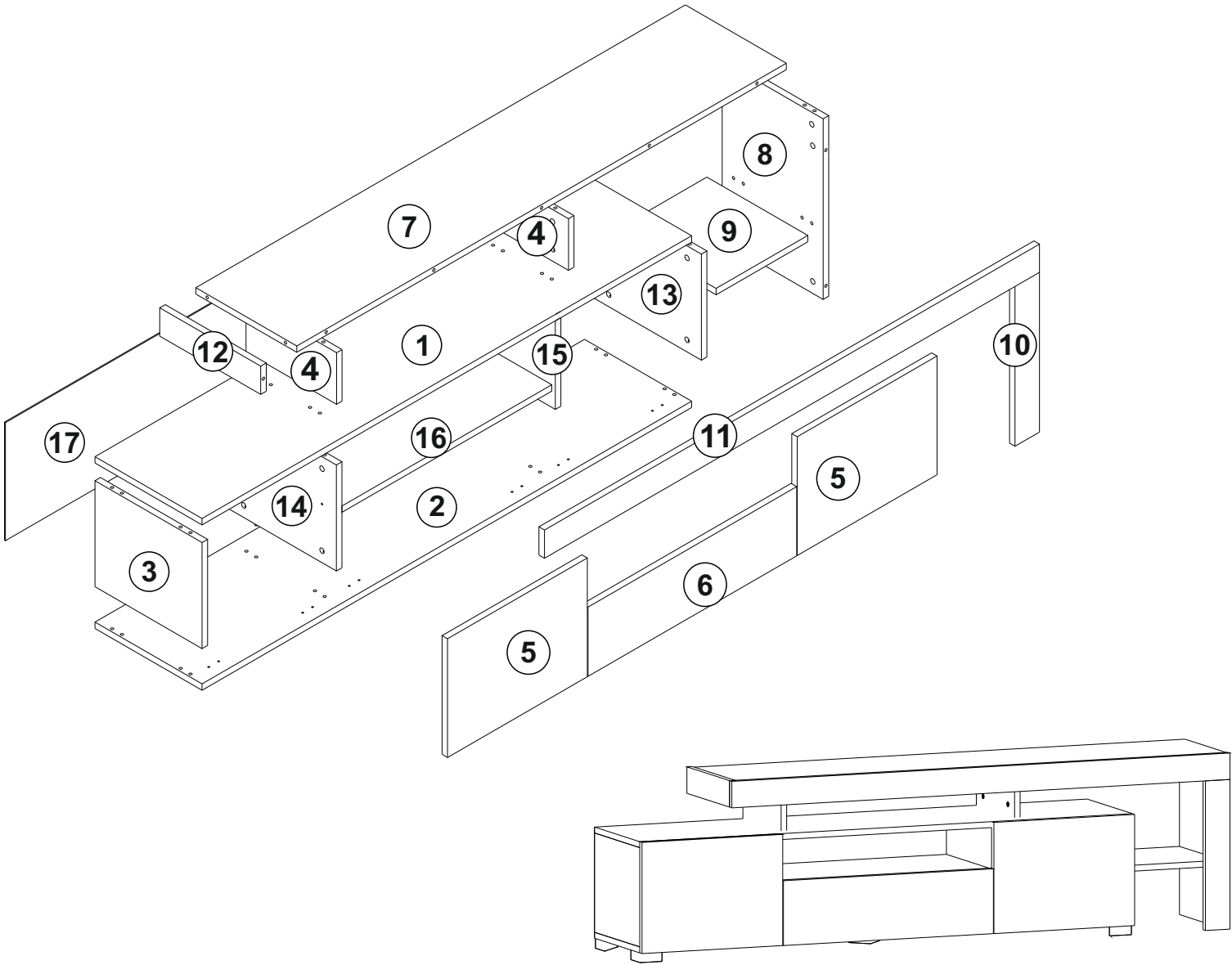
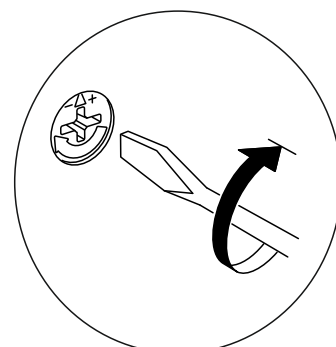
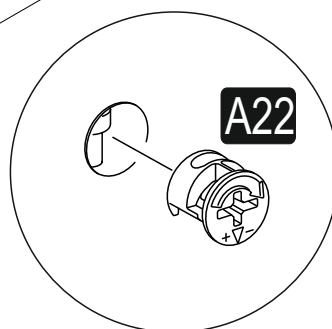
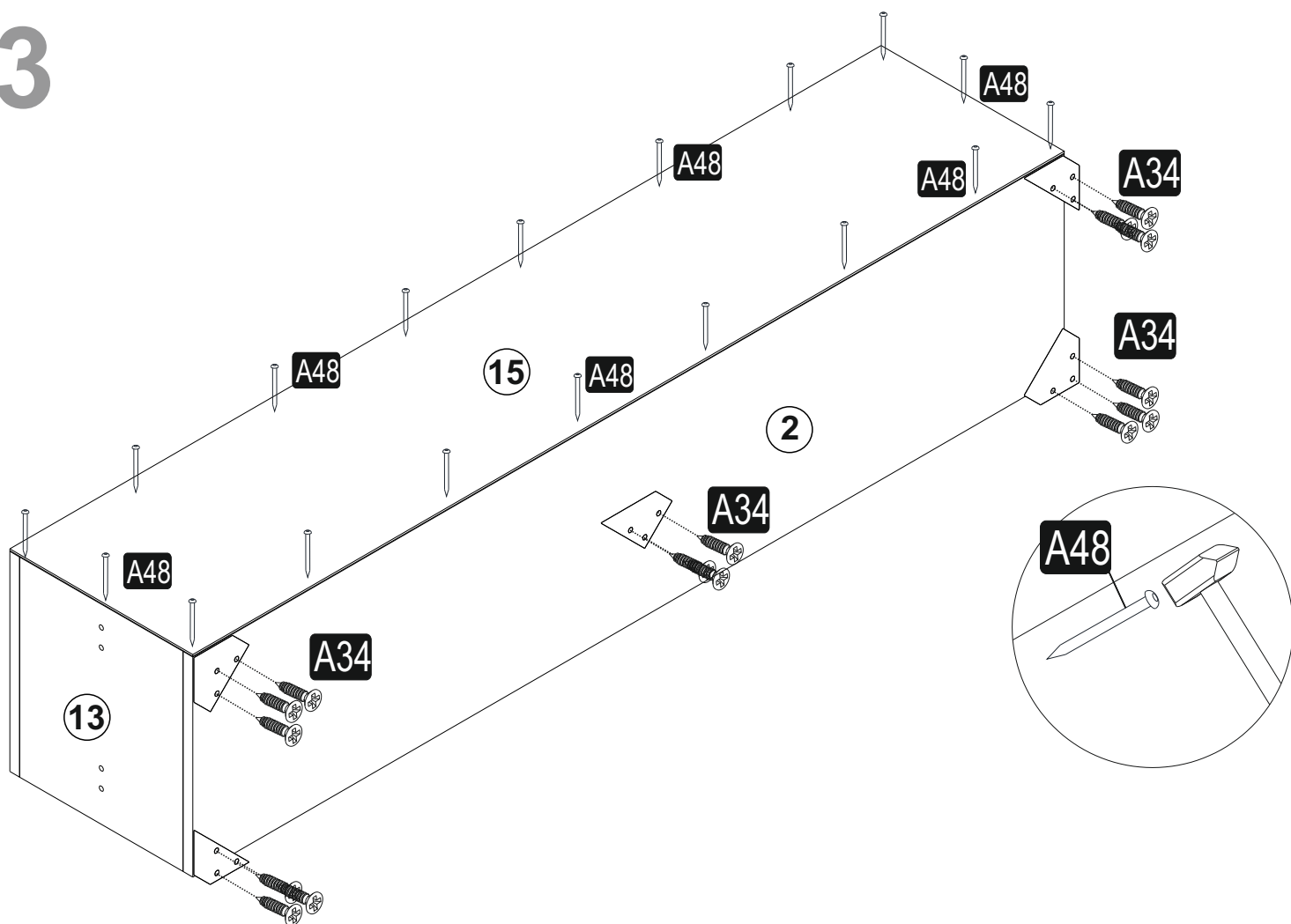

Diagram 1 illustrates the process of attaching the back panel (15) to the frame (16). The back panel (15) is shown being aligned with the frame (16). A hand is shown using a screwdriver to tighten a screw (A17) into the back panel (15) to secure it to the frame (16). The frame (16) is shown with a central rectangular cutout. The back panel (15) is shown with a central rectangular cutout that aligns with the cutout in the frame (16). The back panel (15) is shown with a central rectangular cutout that aligns with the cutout in the frame (16).



④

3



4

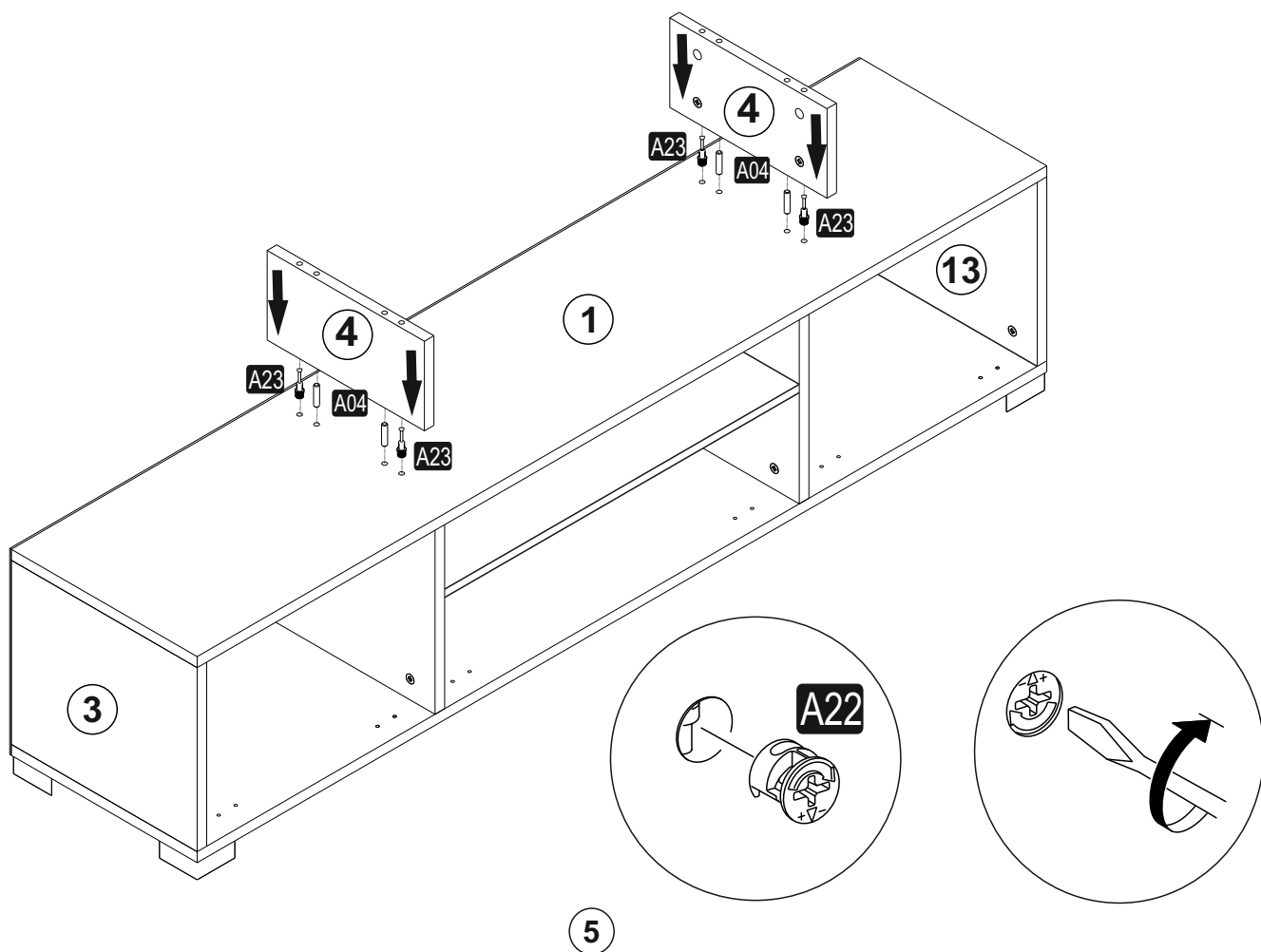

5

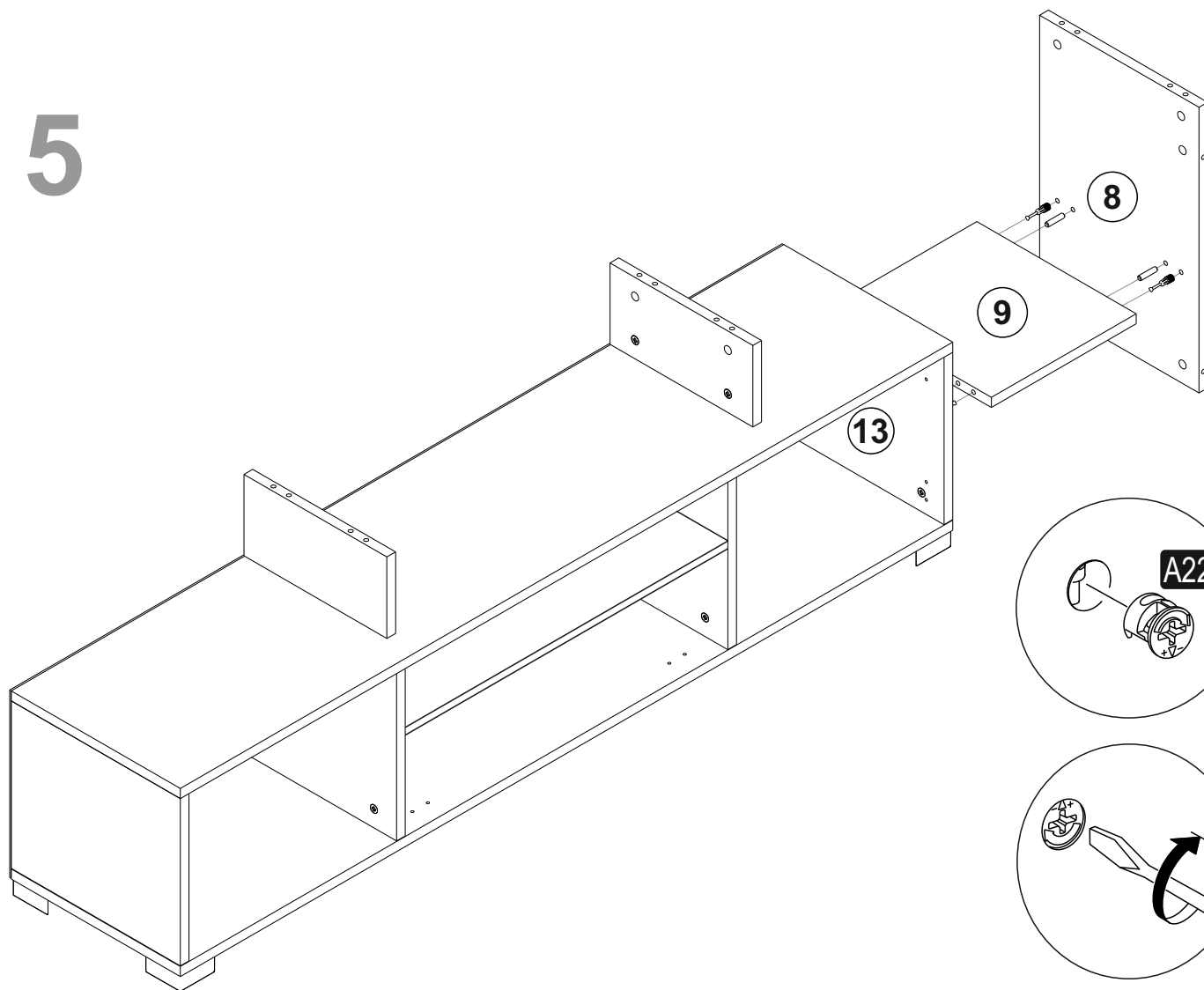

6

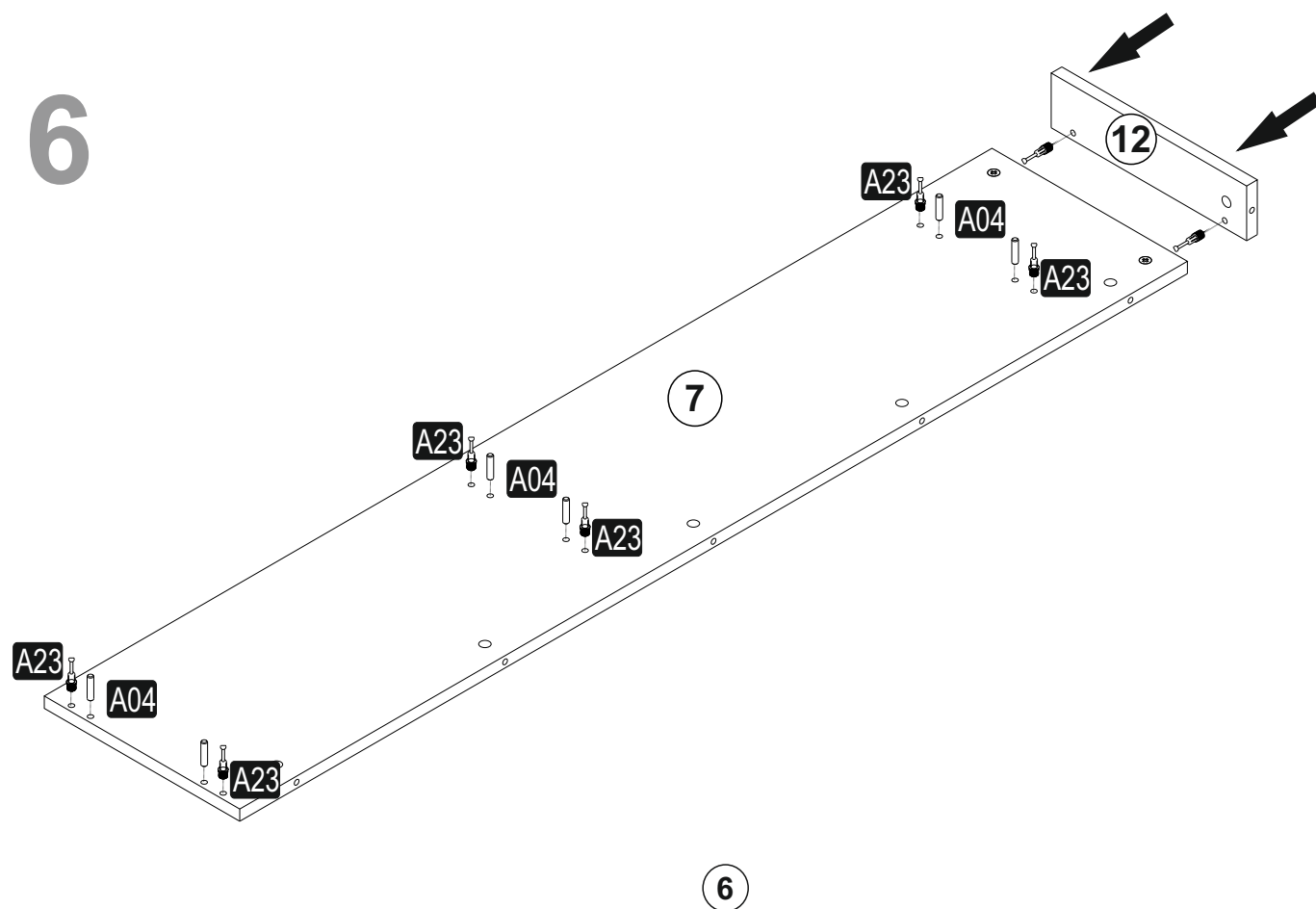

7

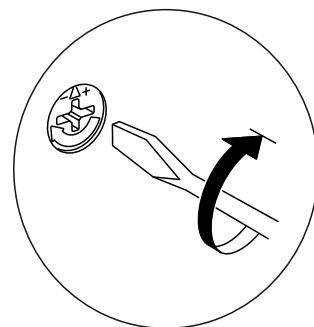
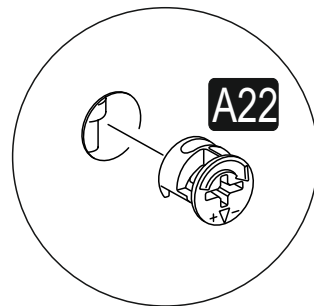
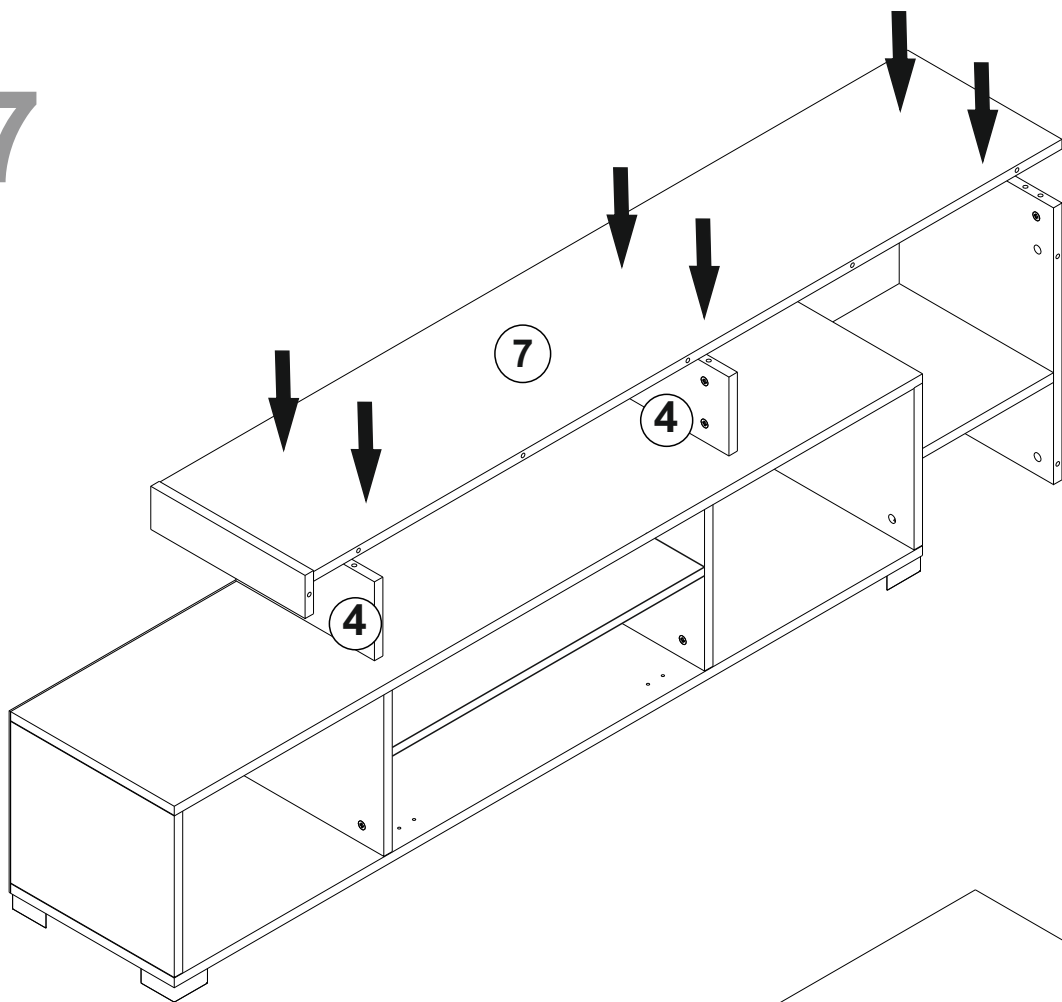

8

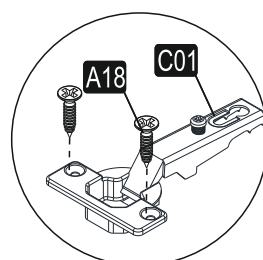
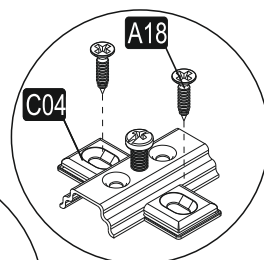
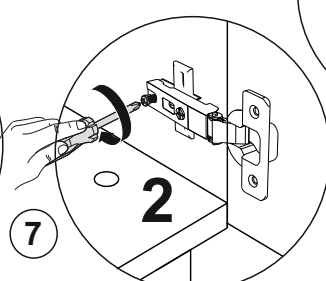
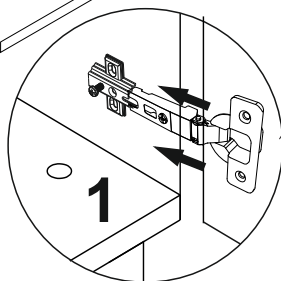
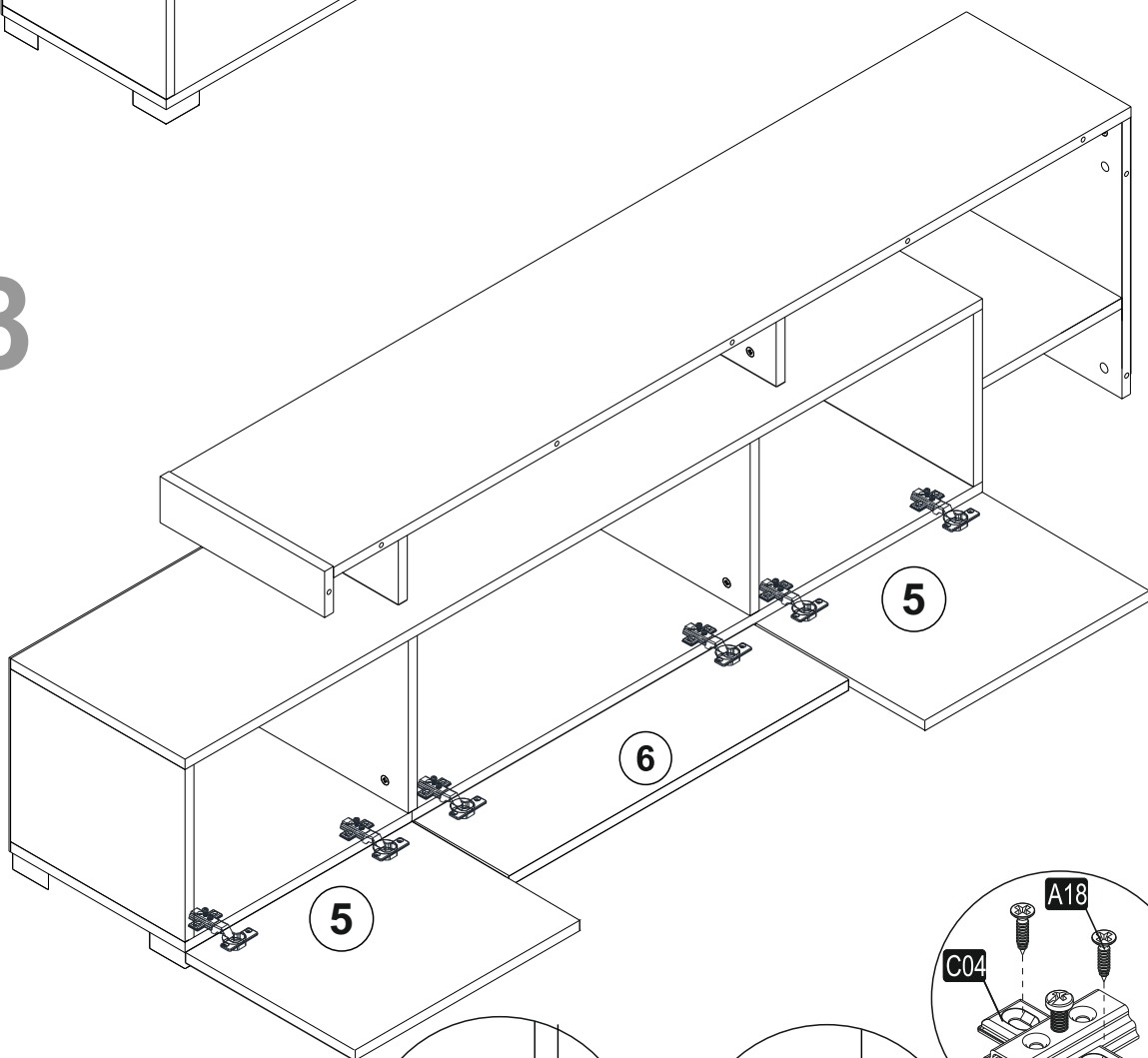

9

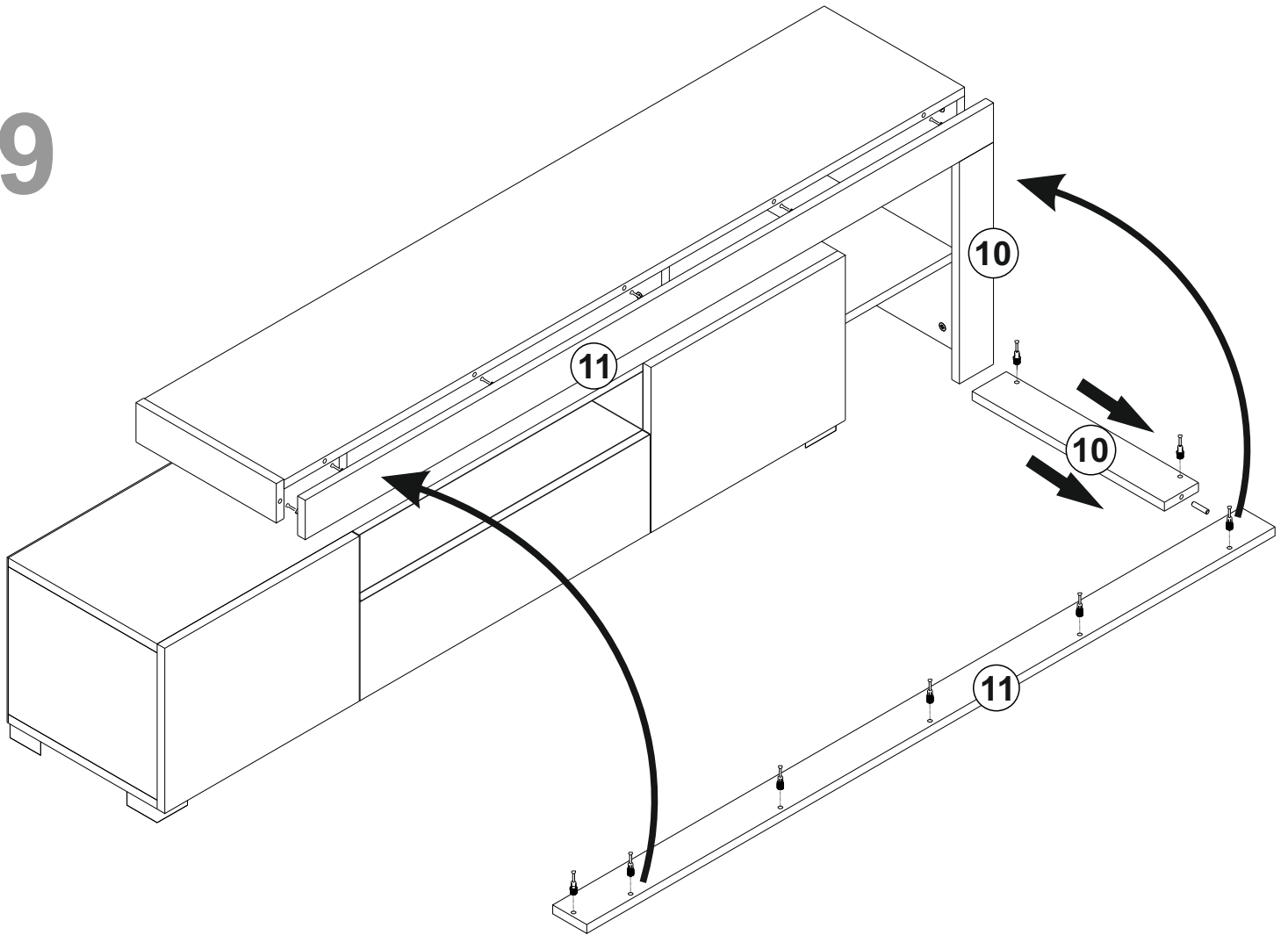

10

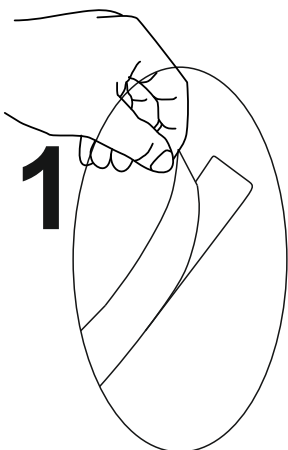
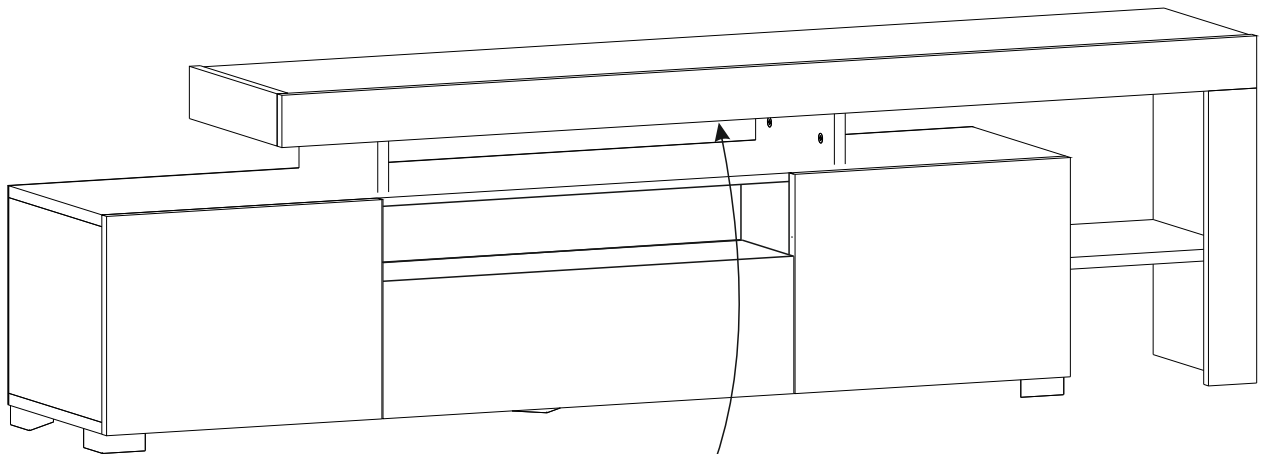

1

2

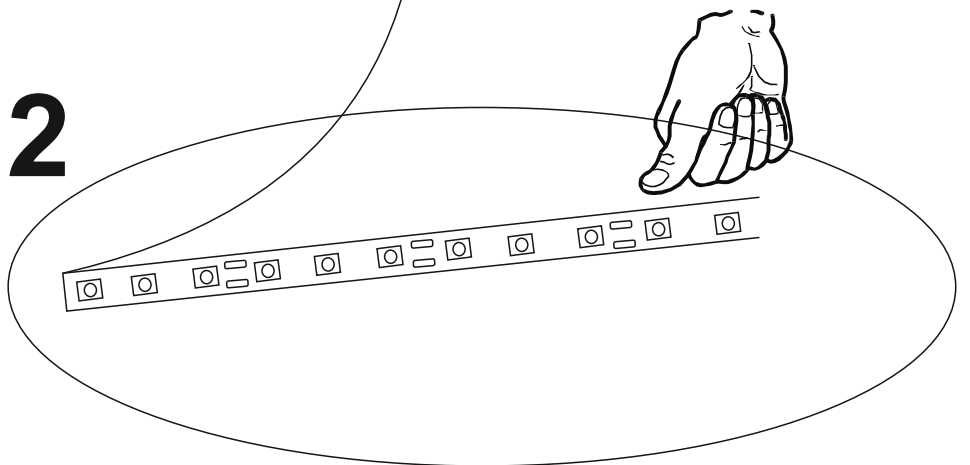

8