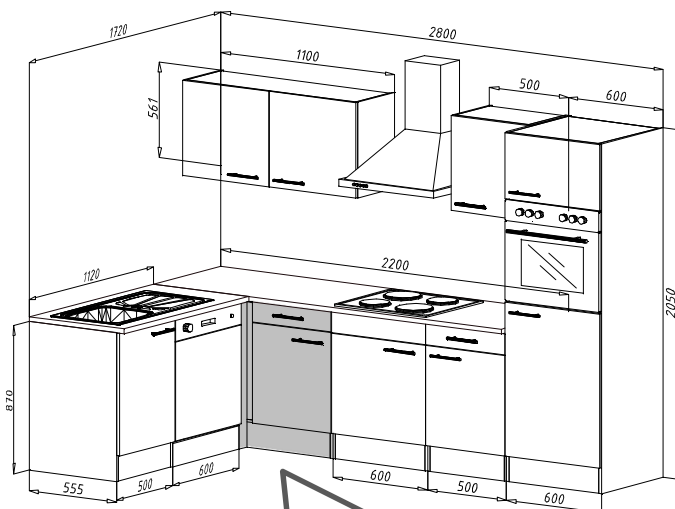
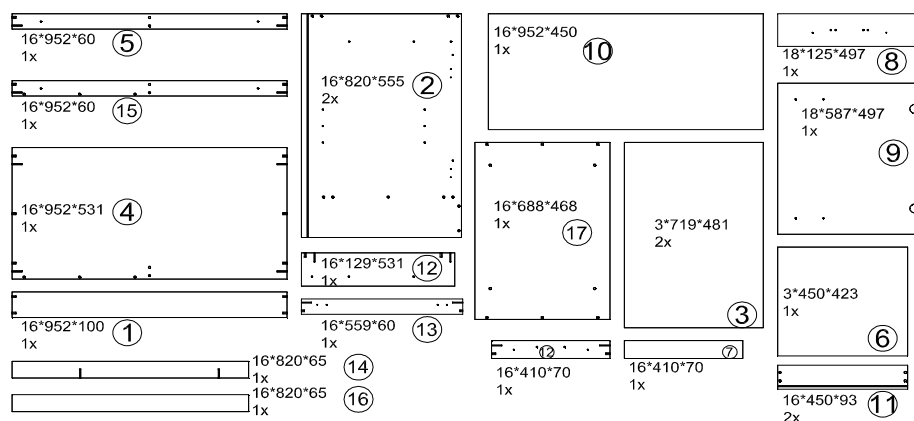
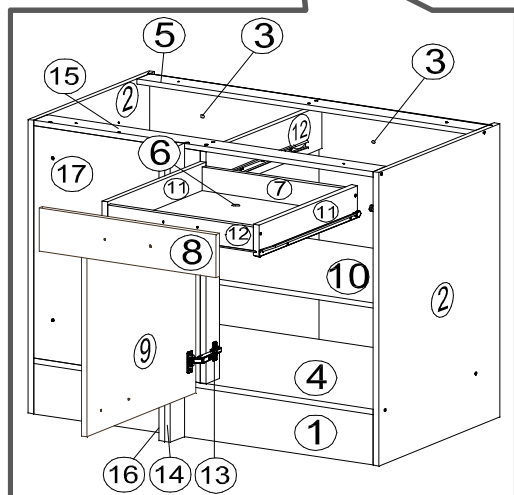
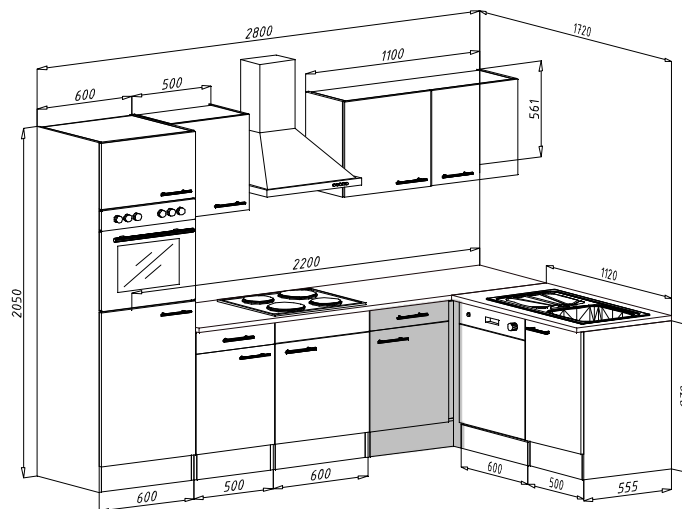

 Bohrer Ø3 Bohrer Ø5
 drill bit Ø3 drill bit Ø5

60min

Mögliche Kombinationen/Possible combinations:
A. VERSION - LINKS/LEFT

B. VERSION - RECHTS/RIGHT

Zum Schutz der Holzteile können Sie rundum die Sockelleiste eine Silikonnaht ziehen.
 To protect the wooden parts you can pull a silicone seam around the skirting board.



Die Fronten (8. 9.) befinden sich in Packstück
 KB110F_SG1

The fronts (8. 9.) are in package KB110F_SG1

| | | | | | |
|---------------------------------|-------------------------------|---|---------------------------------|----------------------------------|------------------------------|
| KO 01 8*30 24 X | KN 03 7*50 15 X | PL 12 4 X | PP 01 4 X | PN 01 2 X | PD 01 2 X |
| VG 03 1 X | EU 01 6*11 6 X | DR 3*16 4 X | DR 27 3,5*16 14 X | DR 25 4*25 5 X | DR 42 4*30 5 X |
| KV 01 1,5*20 20 X | AF 01 1 X | PL 01 1 X | KL 01 4 mm 1 X | UC 10 (128 mm) 2 X | SP 01 2 X |
| UC 04 4*40 2 X | UC 06 2 X | NEG-Novex Grosshandelsgesellschaft für Elektro- und Haustechnik GmbH Chenoverstraße 5 67117 Limburgerhof http://www.respekta.info | | | |

A. VERSION - LINKS/LEFT

B. VERSION - RECHTS/RIGHT

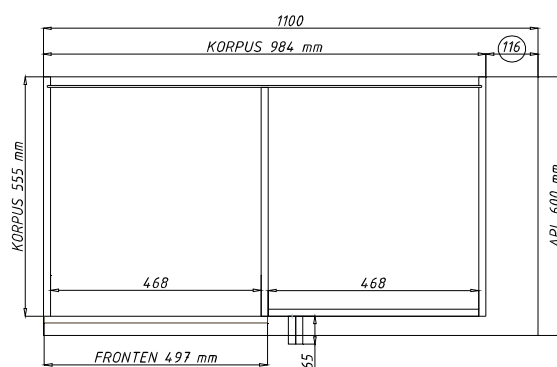
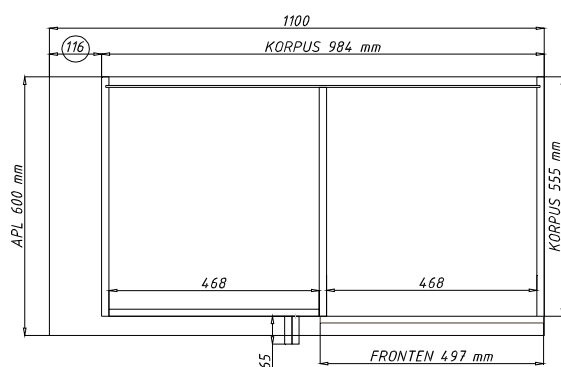
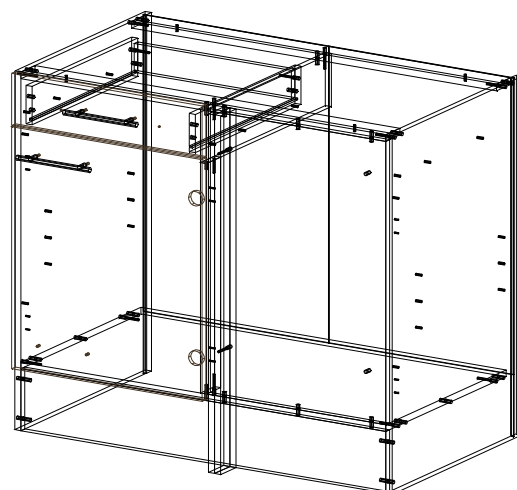
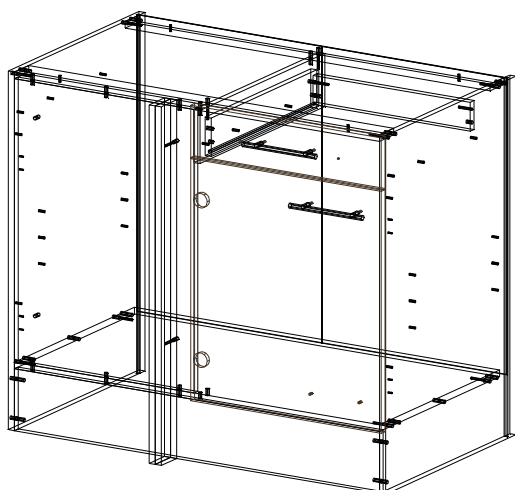

1.

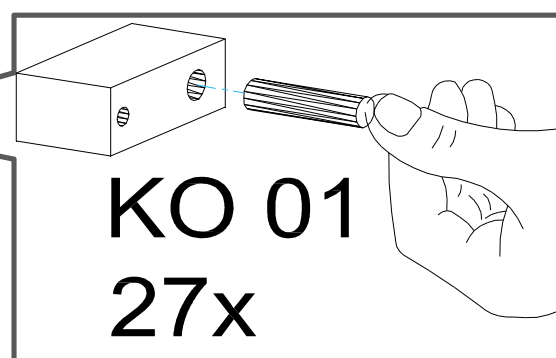
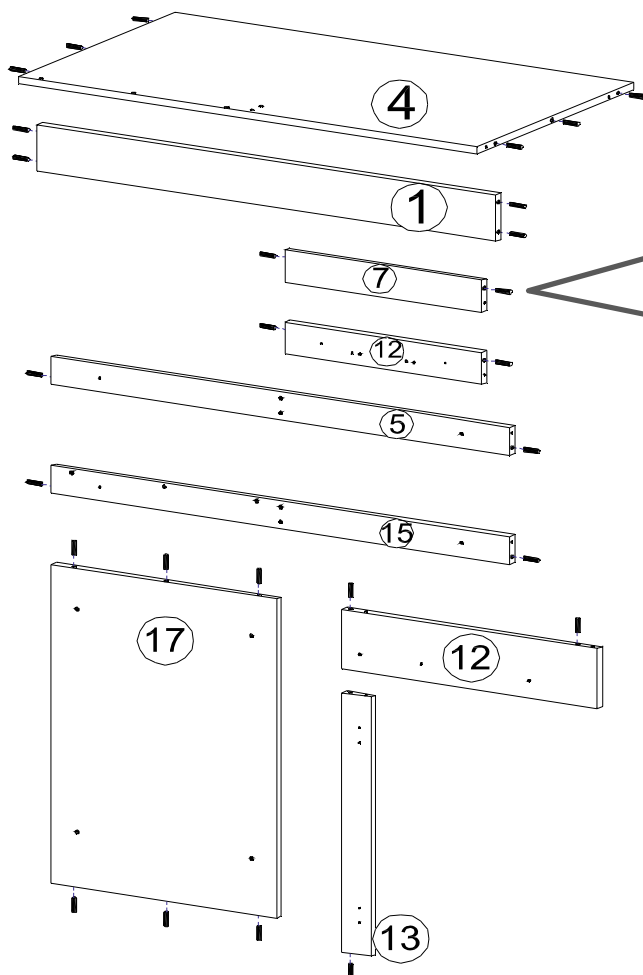

2.

A. VERSION LINKS/LEFT:

3x KN 03

EU 01

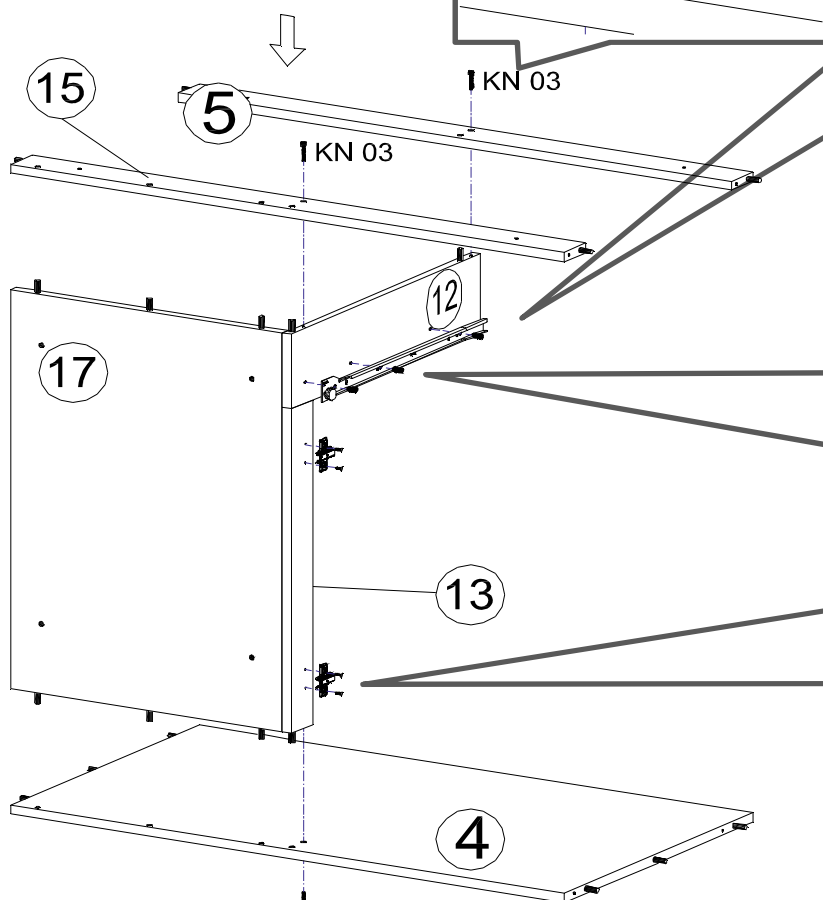

EU 01

2x

DR 27

PD 01

3.

KN 03

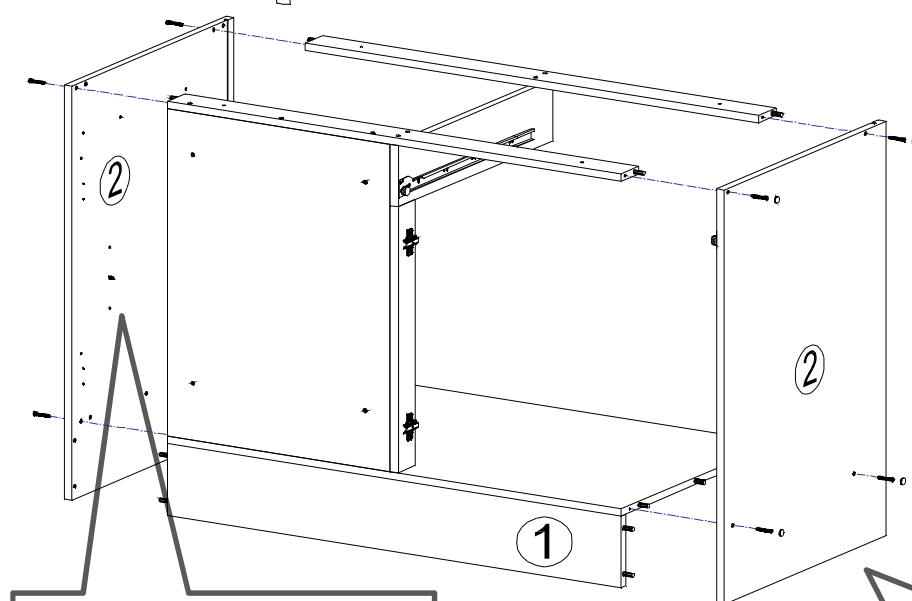

PP 01

4x

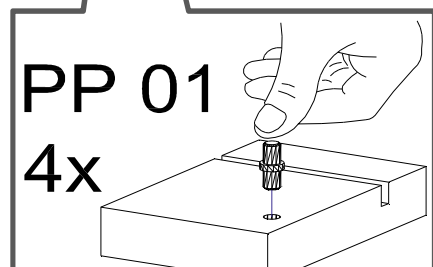

8x

KN 03

PL 12

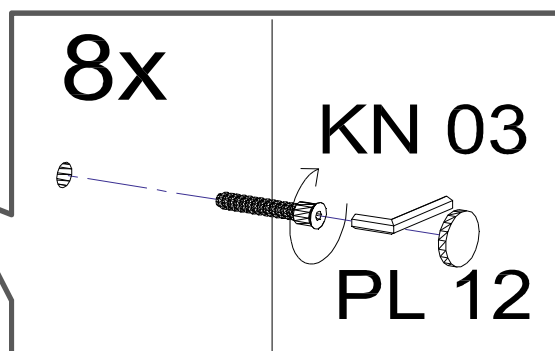

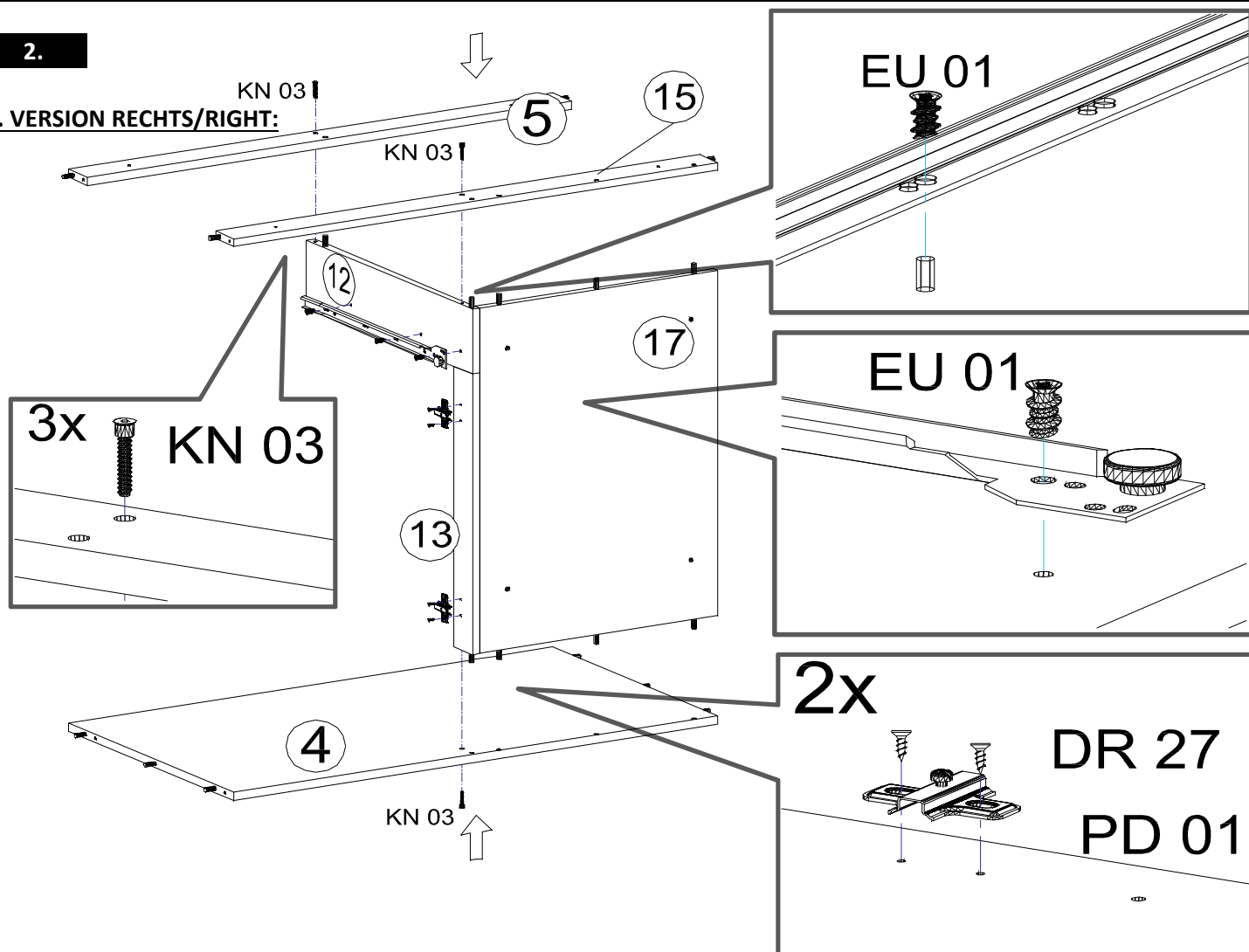
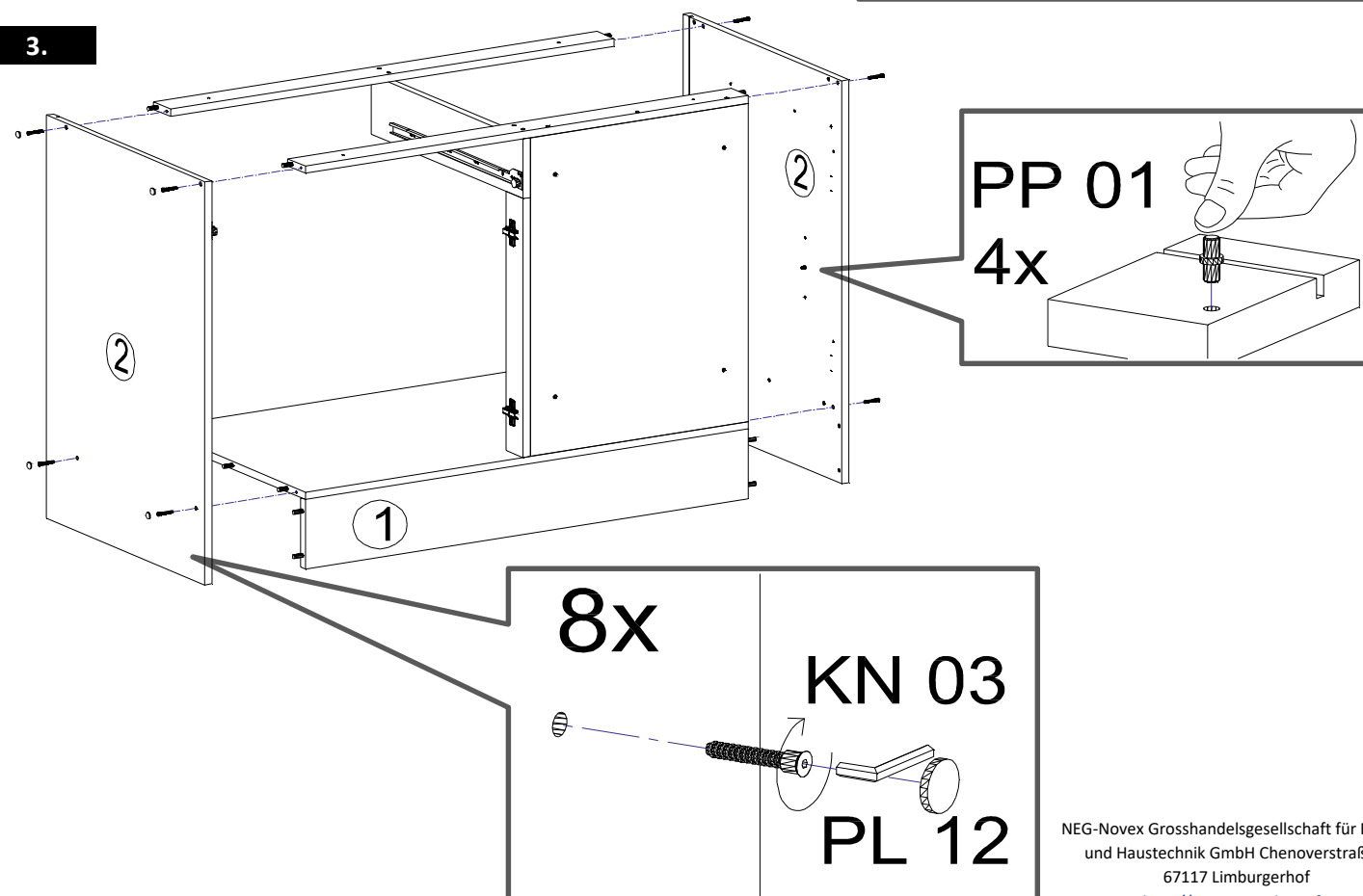
2.**B. VERSION RECHTS/RIGHT:****3.**

4.

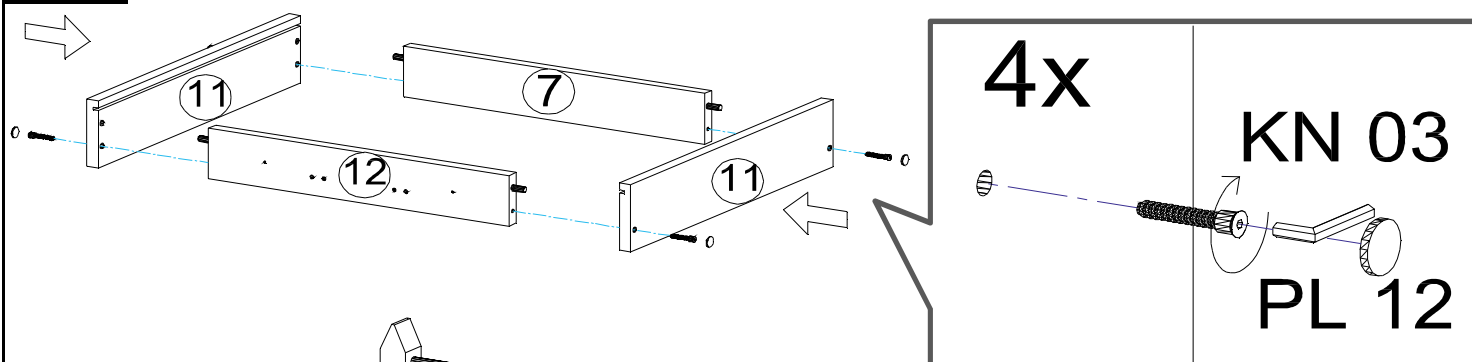

5.

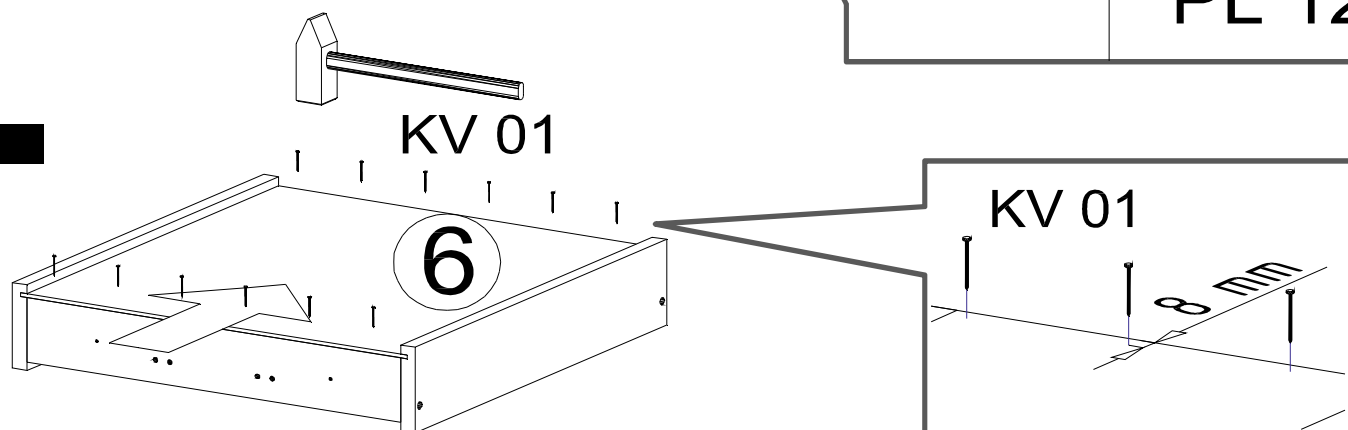

6.

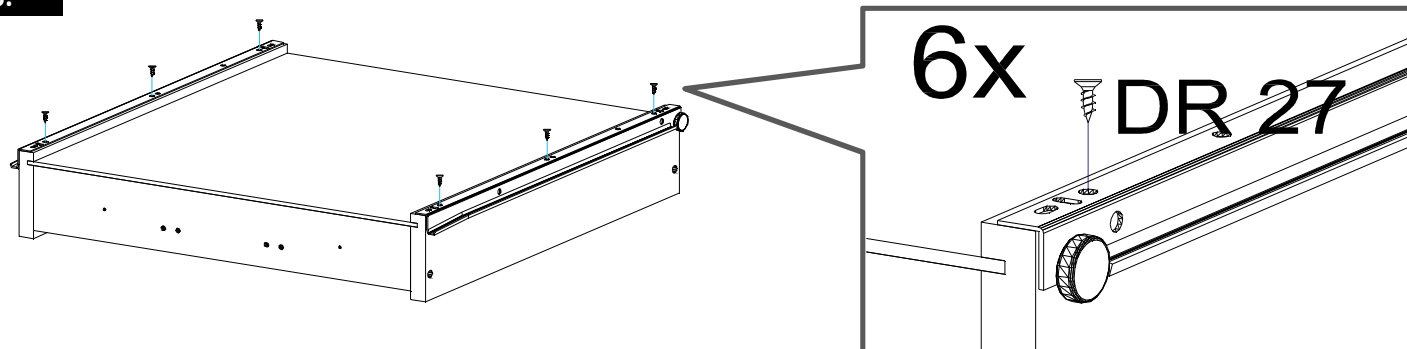

7.

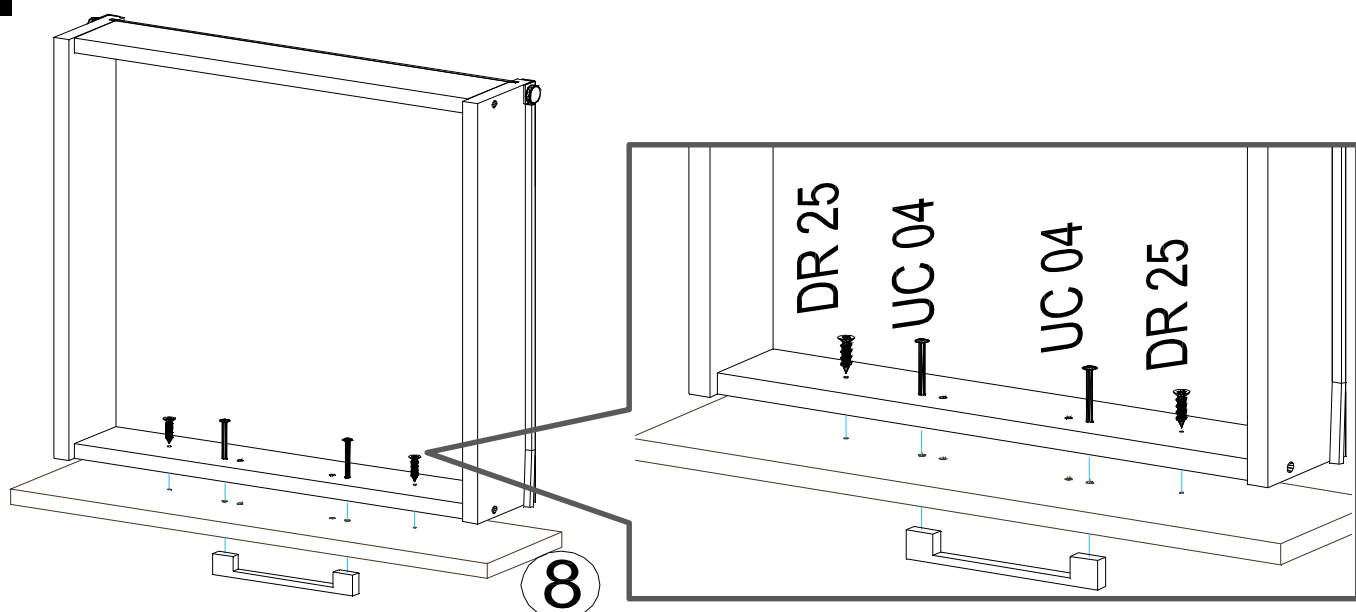

Es gibt einen Bohrungsabstand von 96 und 128 mm. Bitte wählen Sie zum gewählten Griff den richtigen Bohrungsabstand aus.

There is a bore spacing of 96 and 128 mm. Please select the correct hole distance for the selected handle.

8.

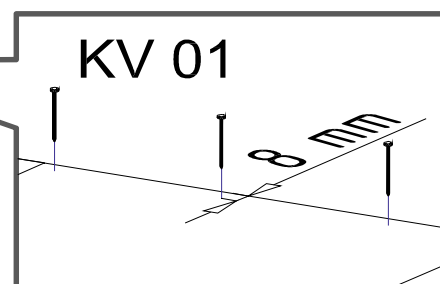
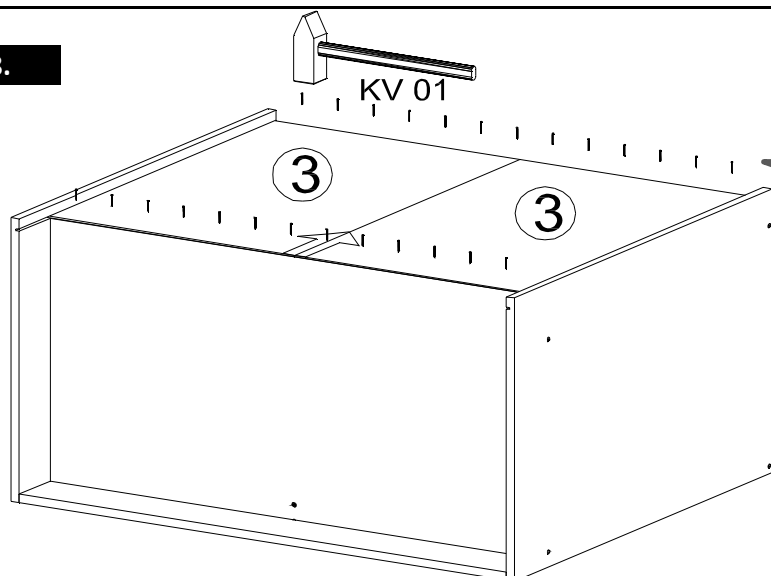

9.

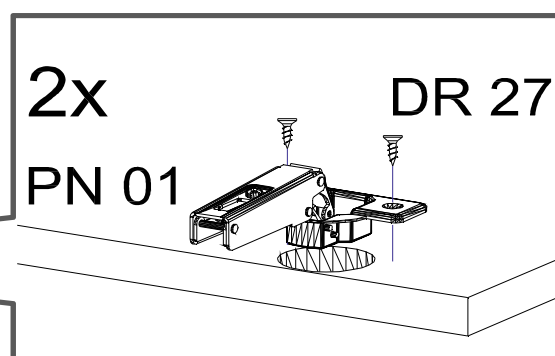
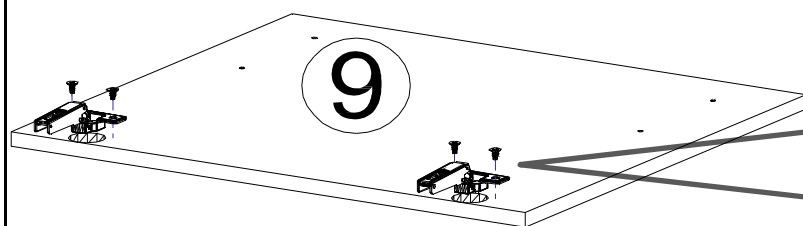

10.

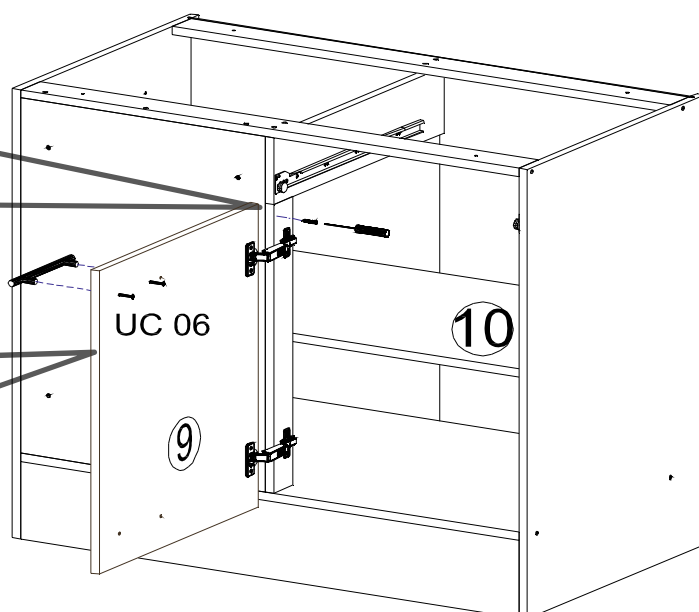
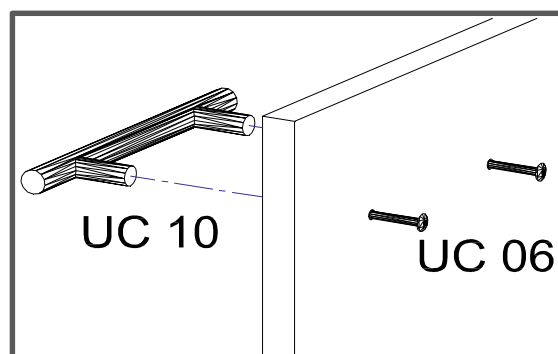
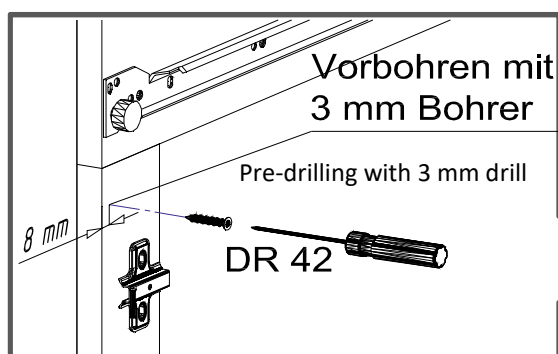

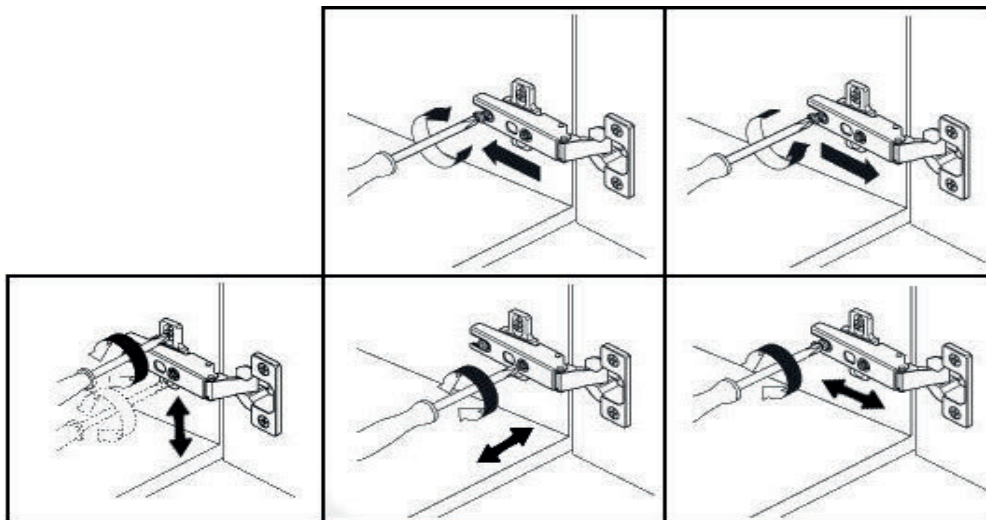

11.

Vorbohren mit 3 mm Bohrer

Pre-drilling with 3 mm drill

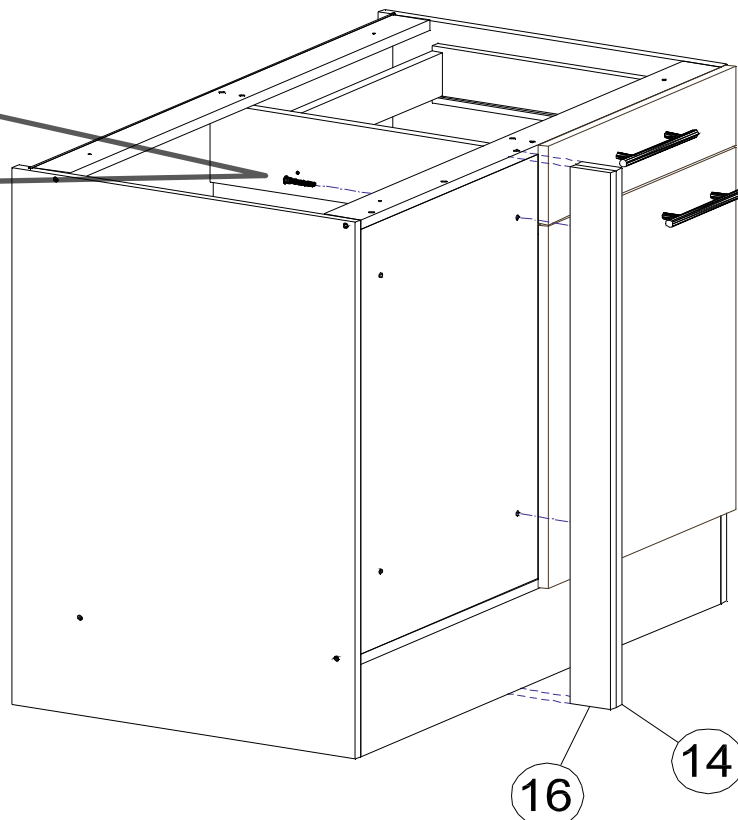
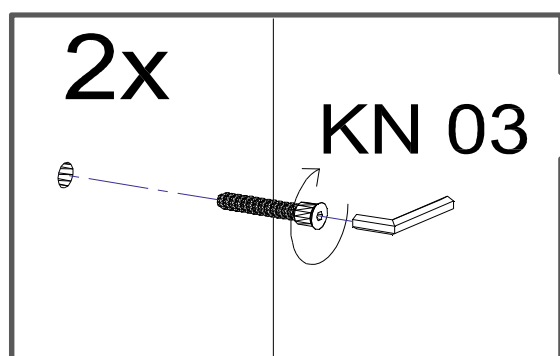
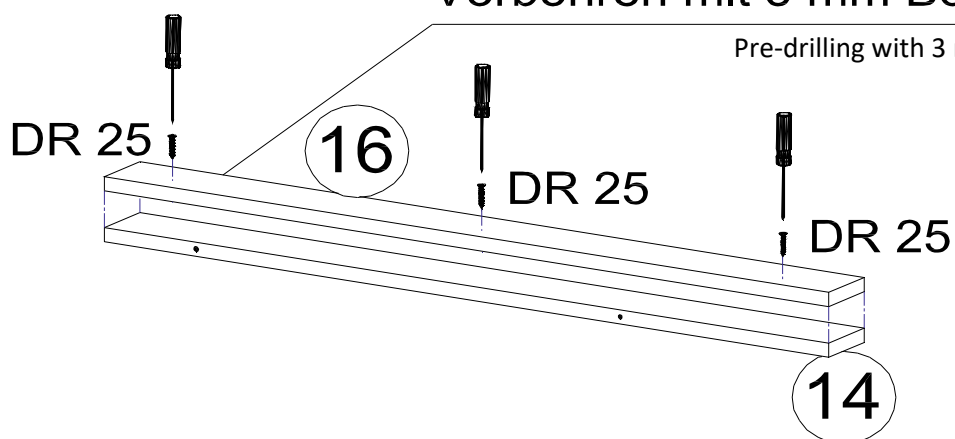

12.

A. VERSION - LINKS/LEFT

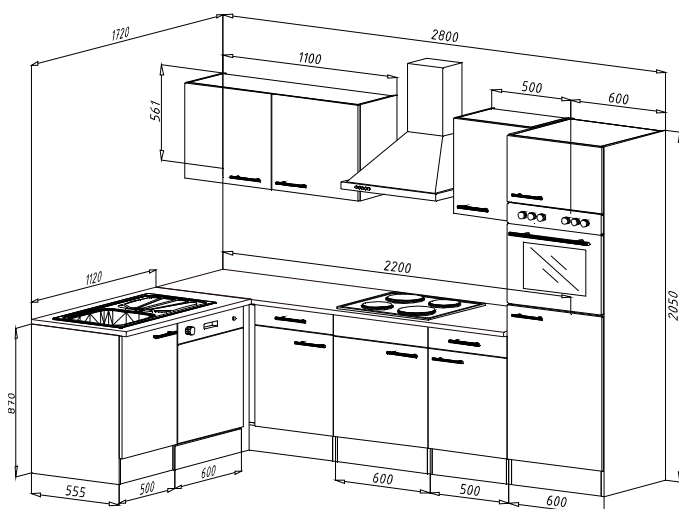

B. VERSION - RECHTS/RIGHT

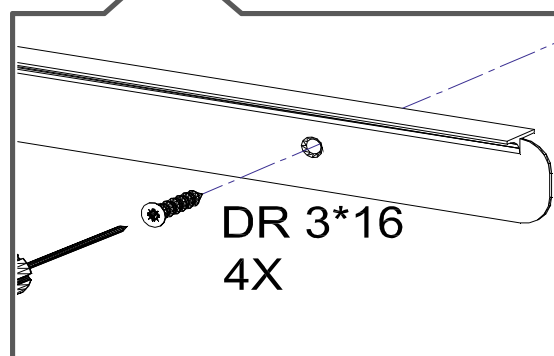
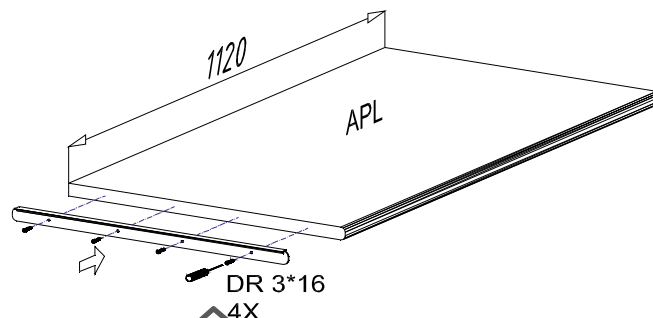
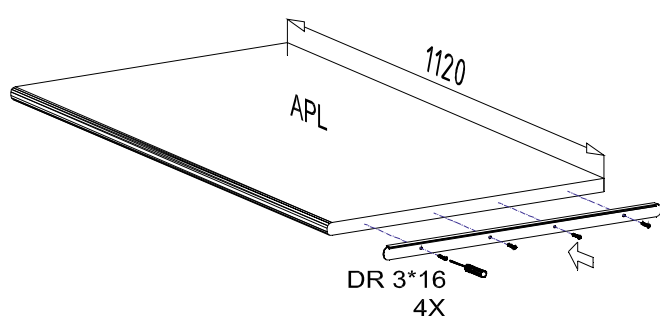
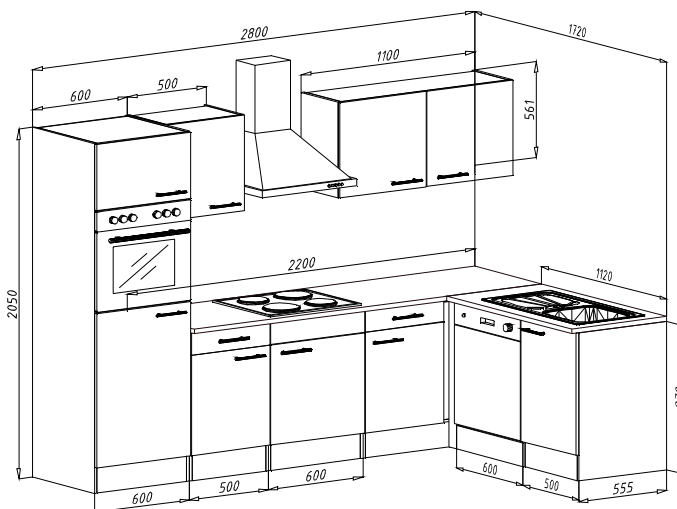

Für die Reinigung bitte die folgenden Putzartikel nicht verwenden: Pulver- Basen des Gleichungslöser; Scheuermittel!

Bitte nur Material, wie Baumwolle verwenden!

BEACHTEN SIE BITTE, DASS BEI EINER NICHT FACHGEMÄSSEN MONTAGE, EV. BEI ÜBERMÄSSIGEN ODER UNGEEIGNETEN BELASTUNG/BESCHWÄRUNG DES MÖBELTEILES DURCH GEGENSTÄNDE ODER PERSONEN ES ZU EINER BESCHÄDIGUNG DES MÖBELSTÜCKES KOMMEN KANN!

Die Möbel nicht permanent in Kontakt mit Wasser bringen.

For cleaning please do not use the following cleaning products: powder bases of the solubilizer; Abrasives!

Please only use material such as cotton!

PLEASE NOTE THAT IN AN INCORRECT ASSEMBLY, EV. IF EXCESSIVE OR UNSUITABLE EXPOSURE / ACCIDENTALISATION OF THE FURNITURE BY OBJECTS OR PERSONS CAN CAUSE IT TO DAMAGE THE FURNITURE PIECE!

Do not bring the furniture into permanent contact with water.

NEG-Novex Grosshandels-gesellschaft für Elektro- und Haustechnik GmbH Chenoverstraße 5
67117 Limburgerhof

<http://www.respekta.info>



30min

KO 01 8*30
34xKN 03 7*50
20xPL 12
20xPN 01
4xPD 01
4xDR 27 3,5*16
16xPP 01
8xKV 01 1,5*20
20xPL 01
1xKL 01 4mm
1xUC 06
4xUC 10 (128 mm)
2x ZUR >270-ER KÜCHEUC 09 (128 mm)
2x ZUR 205-ER KÜCHE

ZUR >270-ER KÜCHE!!

ZUR 205-ER KÜCHE!!

A

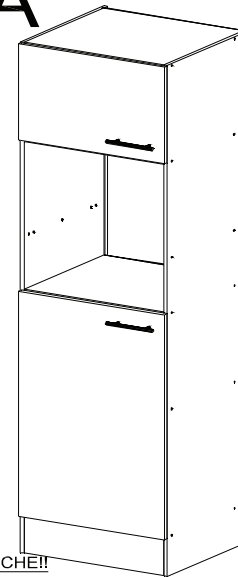

A

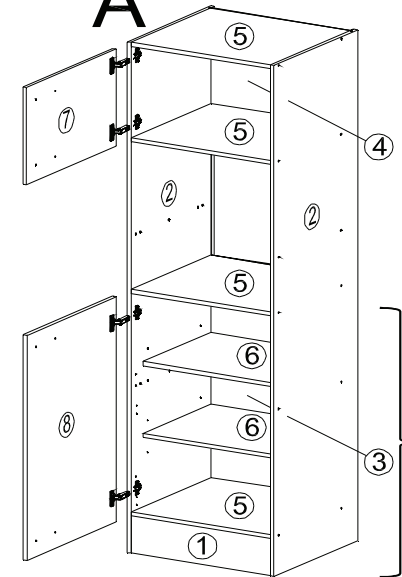

Wenn Sie einen
Kühlschrank
(KS 88.4 A+)
einbauen, bitte die
Teile Nr.3 Nr. 6.
NICHT verwenden!

B

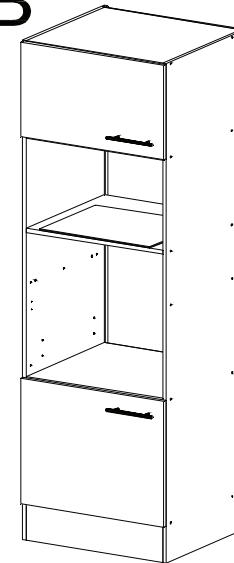

B

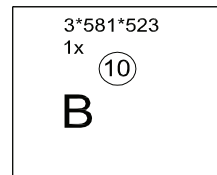
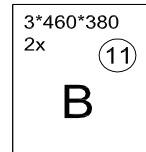
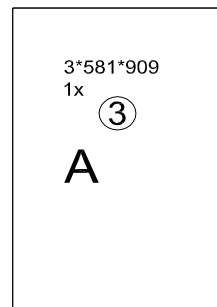
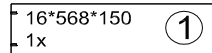
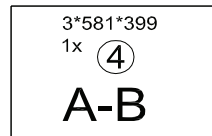
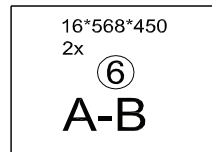
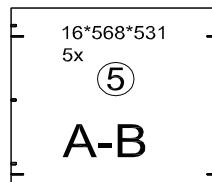
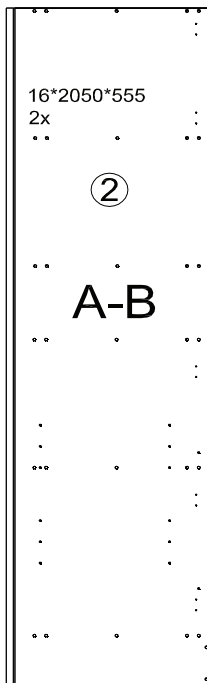
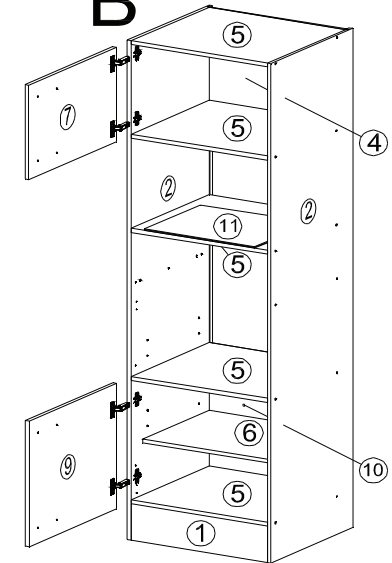
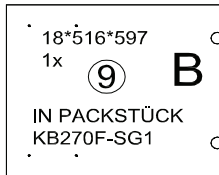
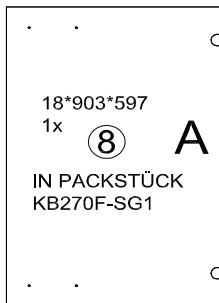
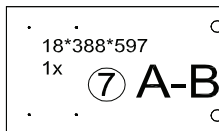
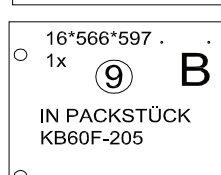
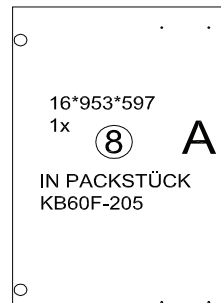
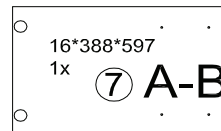
IN PACKSTÜCK
KB270F-SG1IN PACKSTÜCK
KB60F-205

Zum Schutz der Holzteile
können Sie rundum
die Sockelleiste eine
Silikonnaht ziehen.



NEG-Novex Grosshandelsgesellschaft für
Elektro- und Haustechnik GmbH
Chenoverstraße 5
67117 Limburgerhof
<http://www.respekta.info>

1.

A

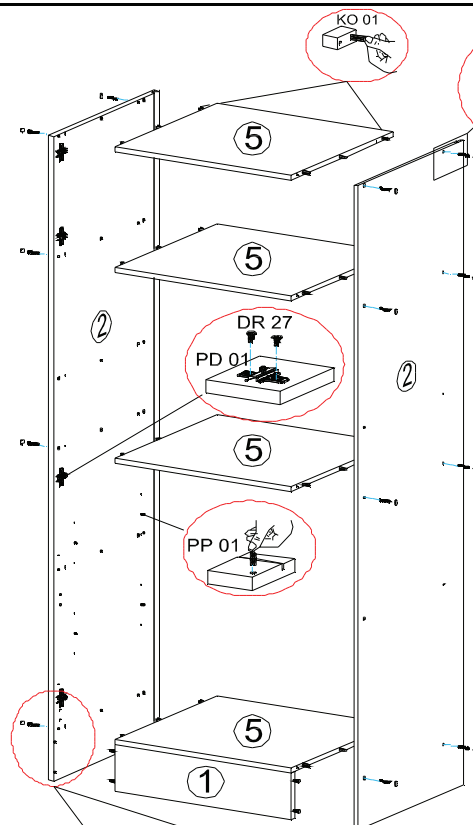

2.

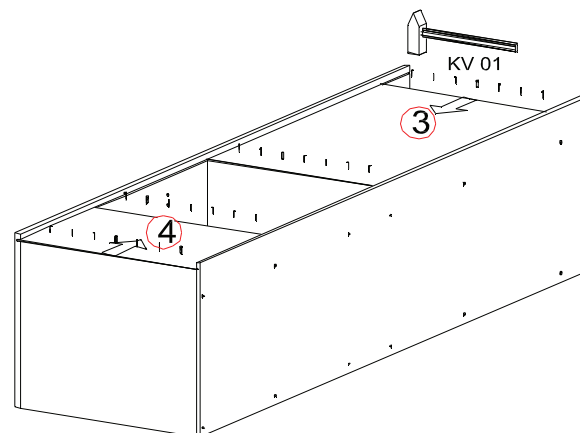

3.

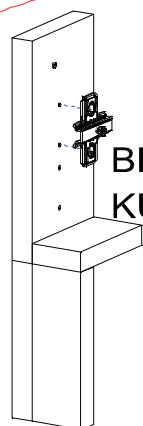
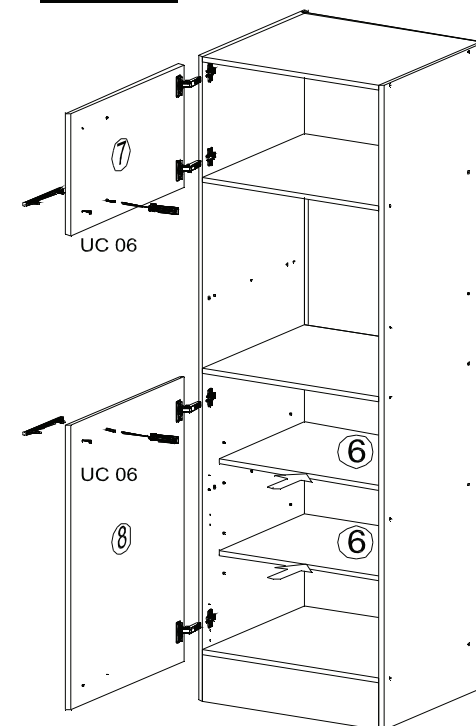

BEI >270-ER
KÜCHE

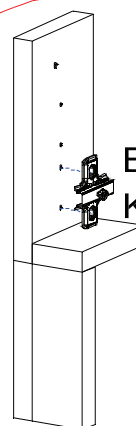

BEI 205-ER
KÜCHE

1.

B

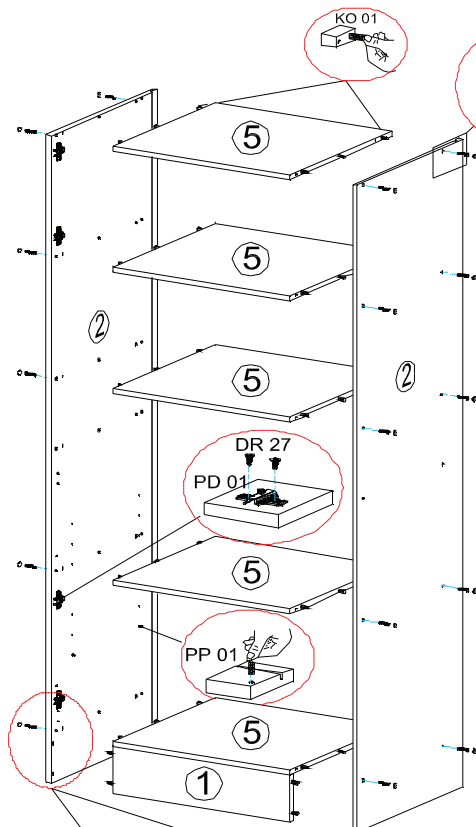

2.

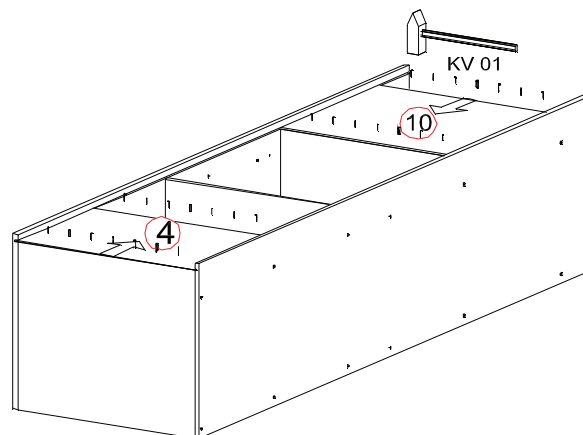

3.

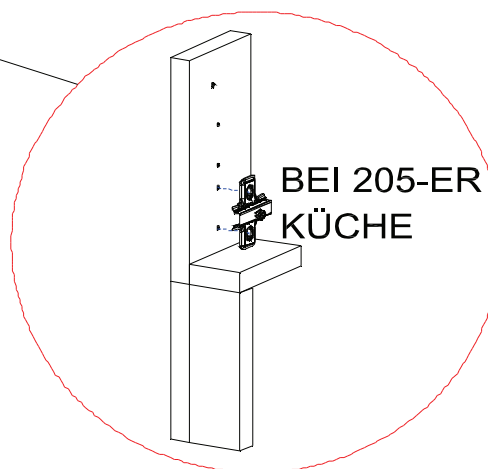
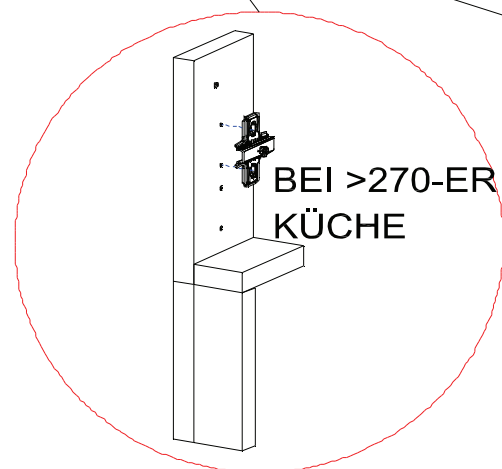
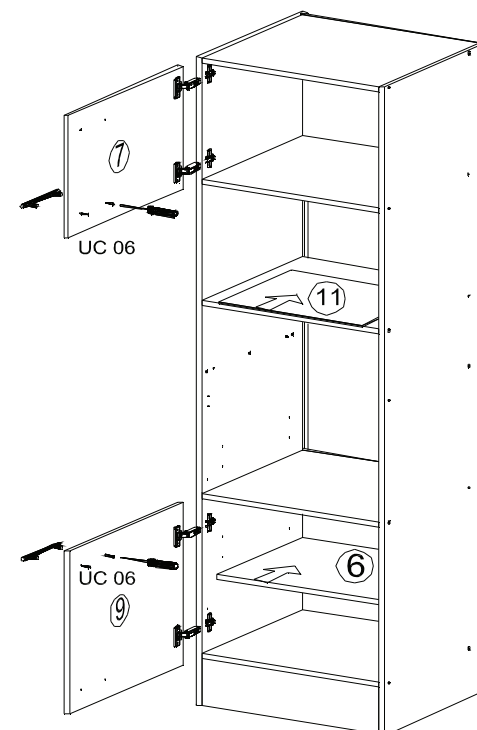

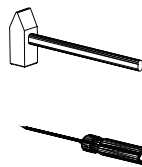
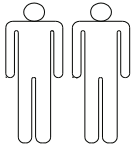

Ø8
Ø5

| | | |
|--------------------------------|---------------------------------|-----------------------------|
| KO 01 8*30 8x | KN 03 7*50 8x | PL 12 8x |
| PP 01 4x | PN 01 2x | PD 01 2x |
| AK 103 2x | DR 27 3,5*16 8x | DR 42 4*30 4x |
| KV 01 1,5*20 10x | PL 16 2x | HK 01 2x |
| PL 01 1x | UC 10 (128 mm) 1x | UC 06 2x |
| KL 01 4mm 1x | SP 01 2x | |

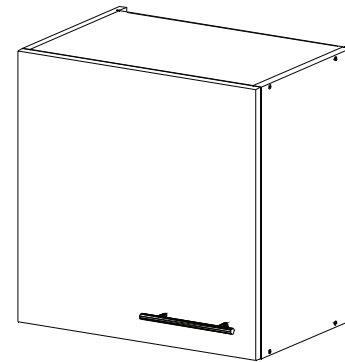

16*561*330
2x

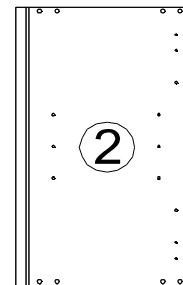

16*468*280
1x
④

16*468*306
2x
①

3*559*481
1x
③

18*559*497
1x
⑤
IN PACKSTÜCK
KB270F-SG2

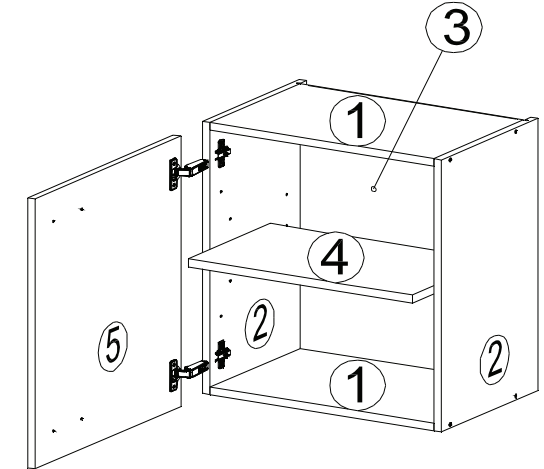

DE Eine unsachgemäße Befestigung der Hängebeschläge / Wandbefestigung kann zur Ablösung der Hängeschränke aus der Wand führen.

Benutzen Sie unbedingt Dübel, den in Verbindung mit dem Wandmaterial die Tragfähigkeit sicherstellen.

Sollten Sie unsicher sein welchen Typ Dübel und Schrauben Sie benötigen, fragen Sie bitte beim Fachhandel nach.

1.

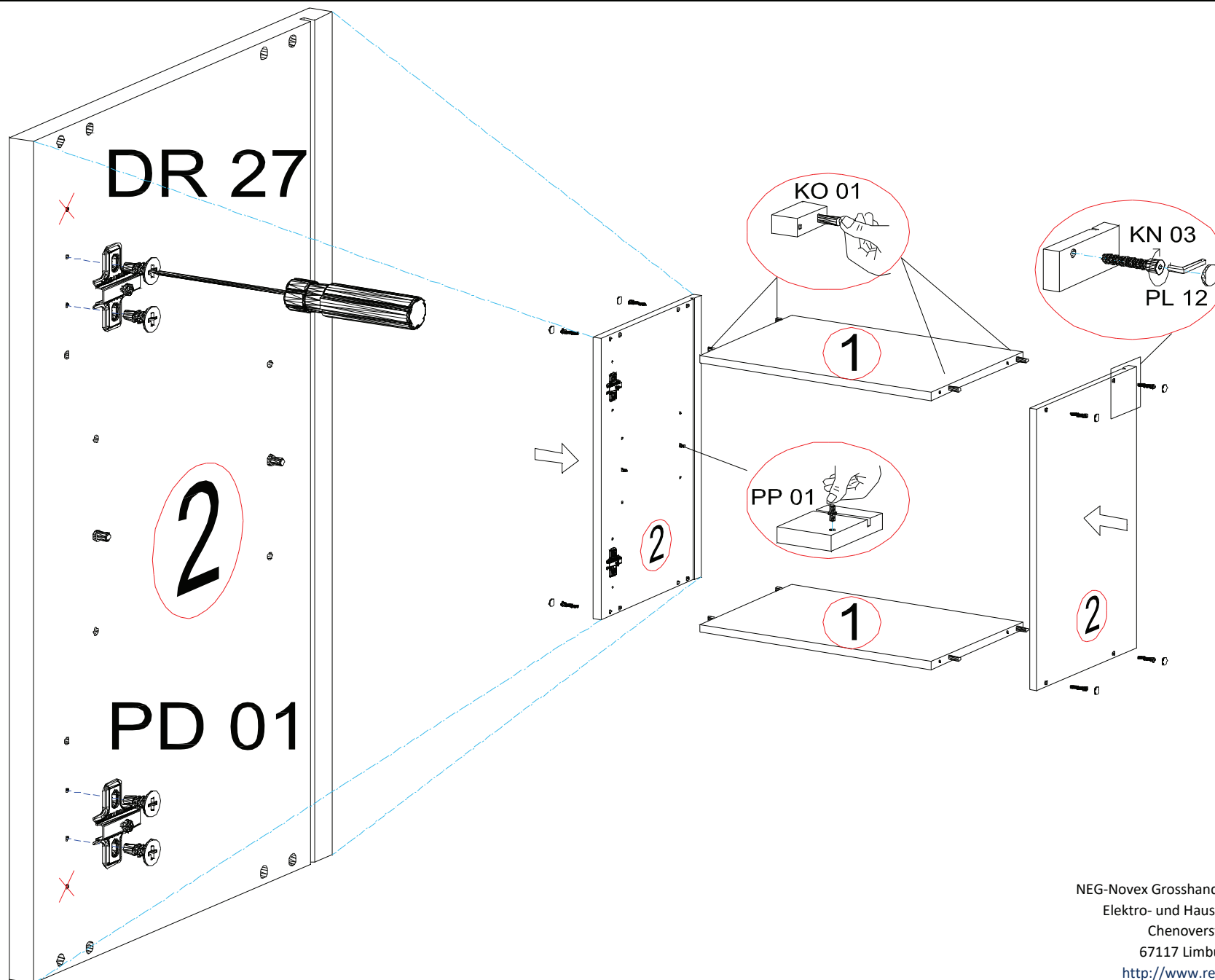

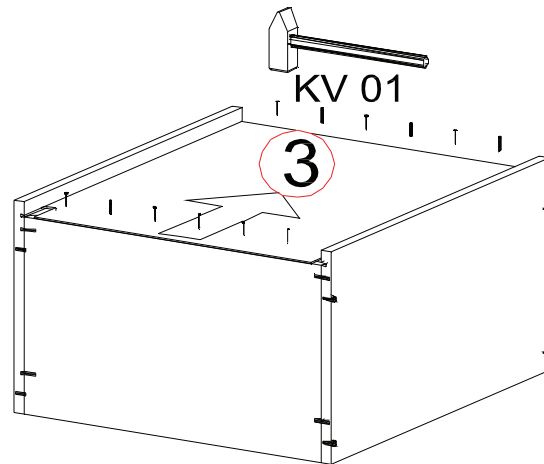
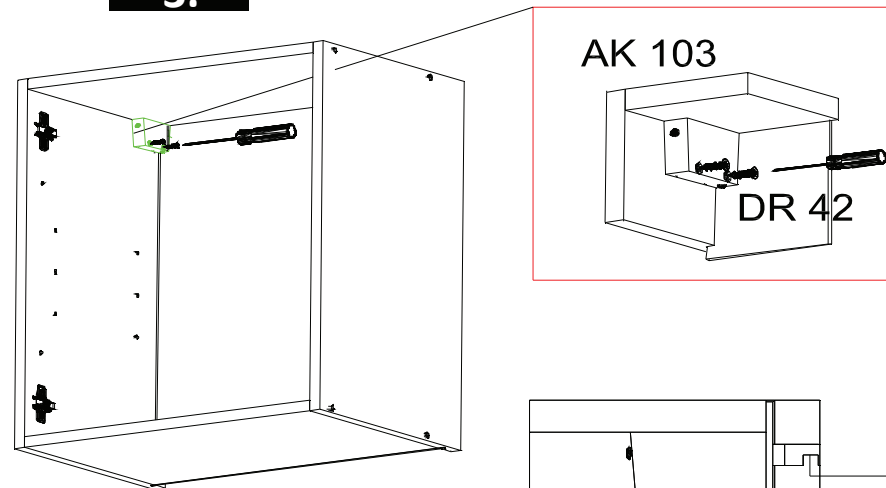
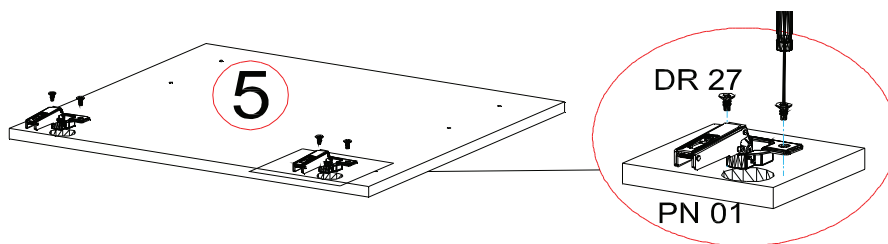
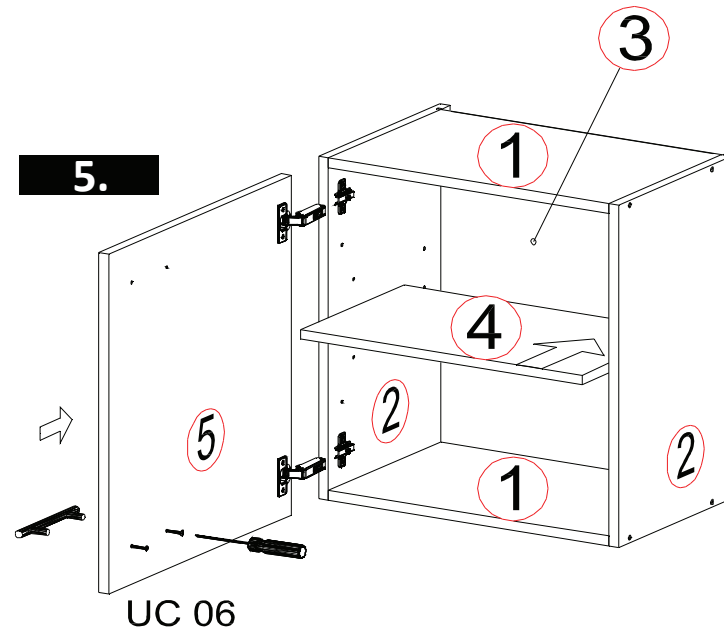
2.**3.****4.****5.**

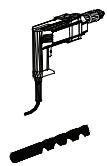
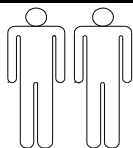

Ø5

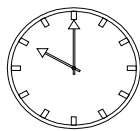
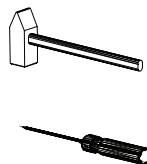

45min

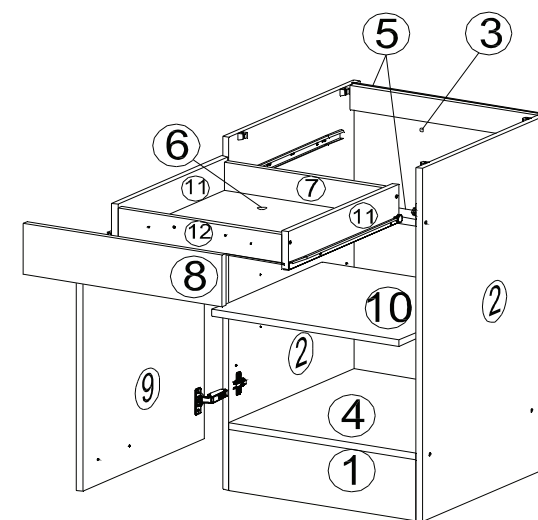
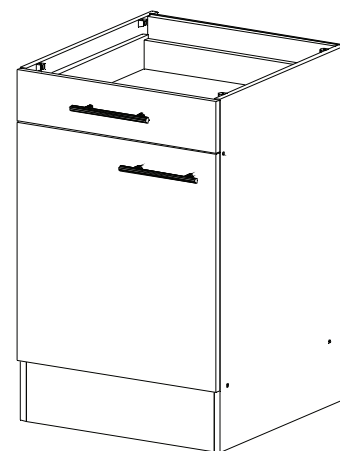
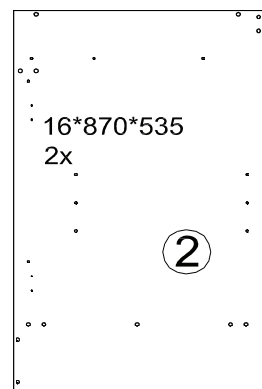
KO 01 8*30
18xKN 03 7*50
12xPL 12
12xPP 01
4xPN 01
2xPD 01
2xVG 03
1xEU 01 6*11
6xDR 27 3,5*16
20xDR 25 4*25
2xDR 42 4*30
4xKV 01 1,5*20
10xPL 01
1xKL 01 4mm
1xUC 06
2xUC 04 4*40
2xUC 10 (128 mm)
2xAK 145
4x16*468*150
1x

①

16*468*60
2x

⑤



Zum Schutz der Holzteile können Sie rundum die
Sockelleiste eine Silikonnaht ziehen.

16*468*450
1x

⑩

3*719*481
1x

③

16*410*70
1x

⑦

16*468*511
1x

④

3*450*423
1x

⑥

16*450*93
2x

⑪

16*410*70
1x

⑫

 IN PACKSTÜCK
KB270F-SG2

 18*125*497
1x

⑧

 18*588*497
1x

⑨

 IN PACKSTÜCK
KB270F-SG2

1.

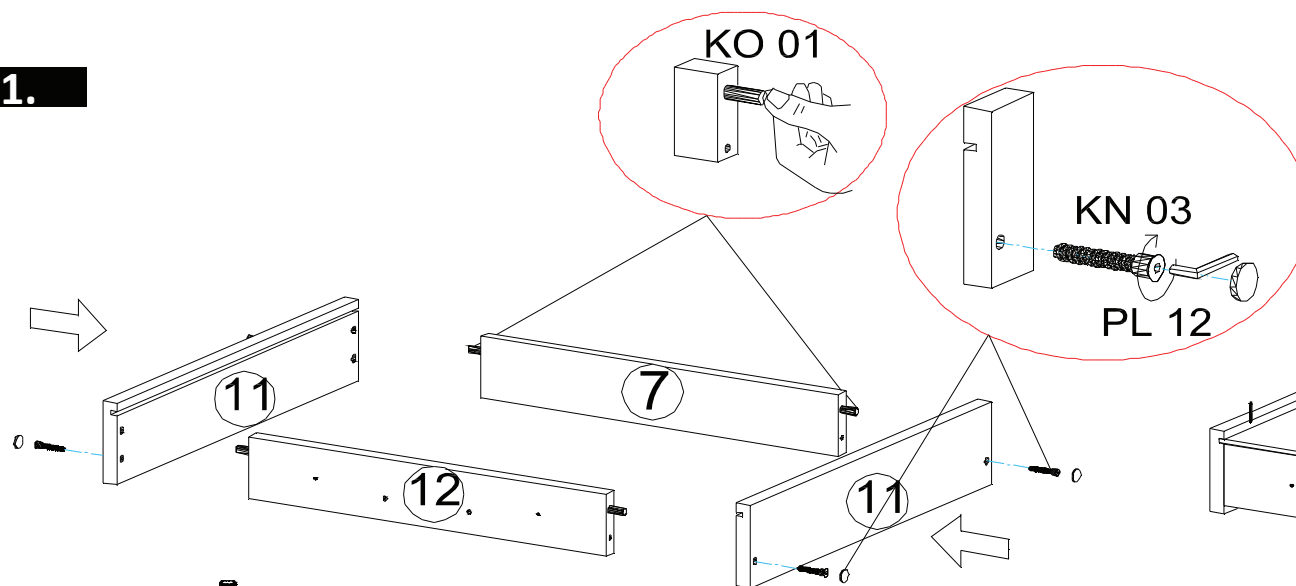

2.

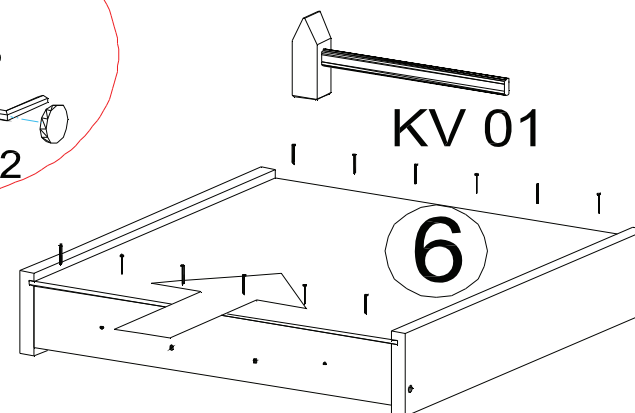

3.

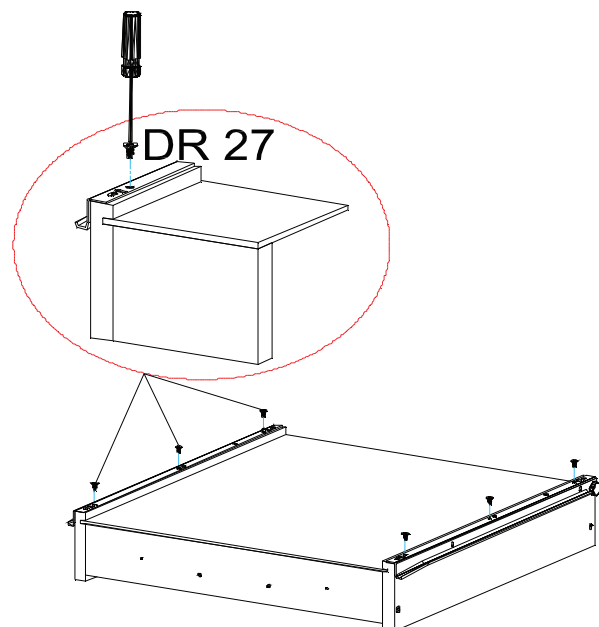

4.

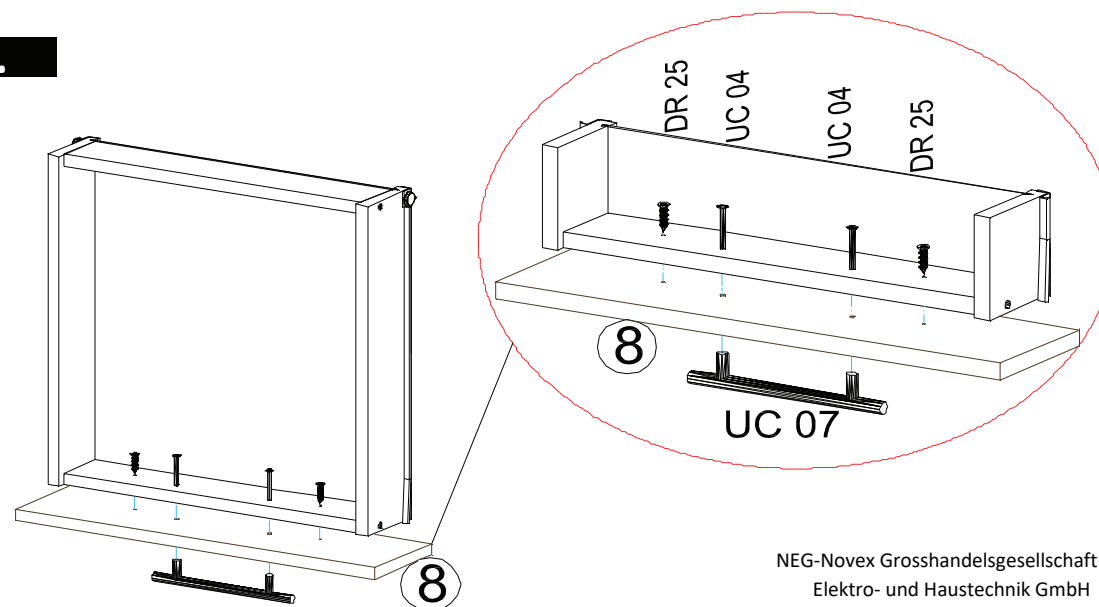

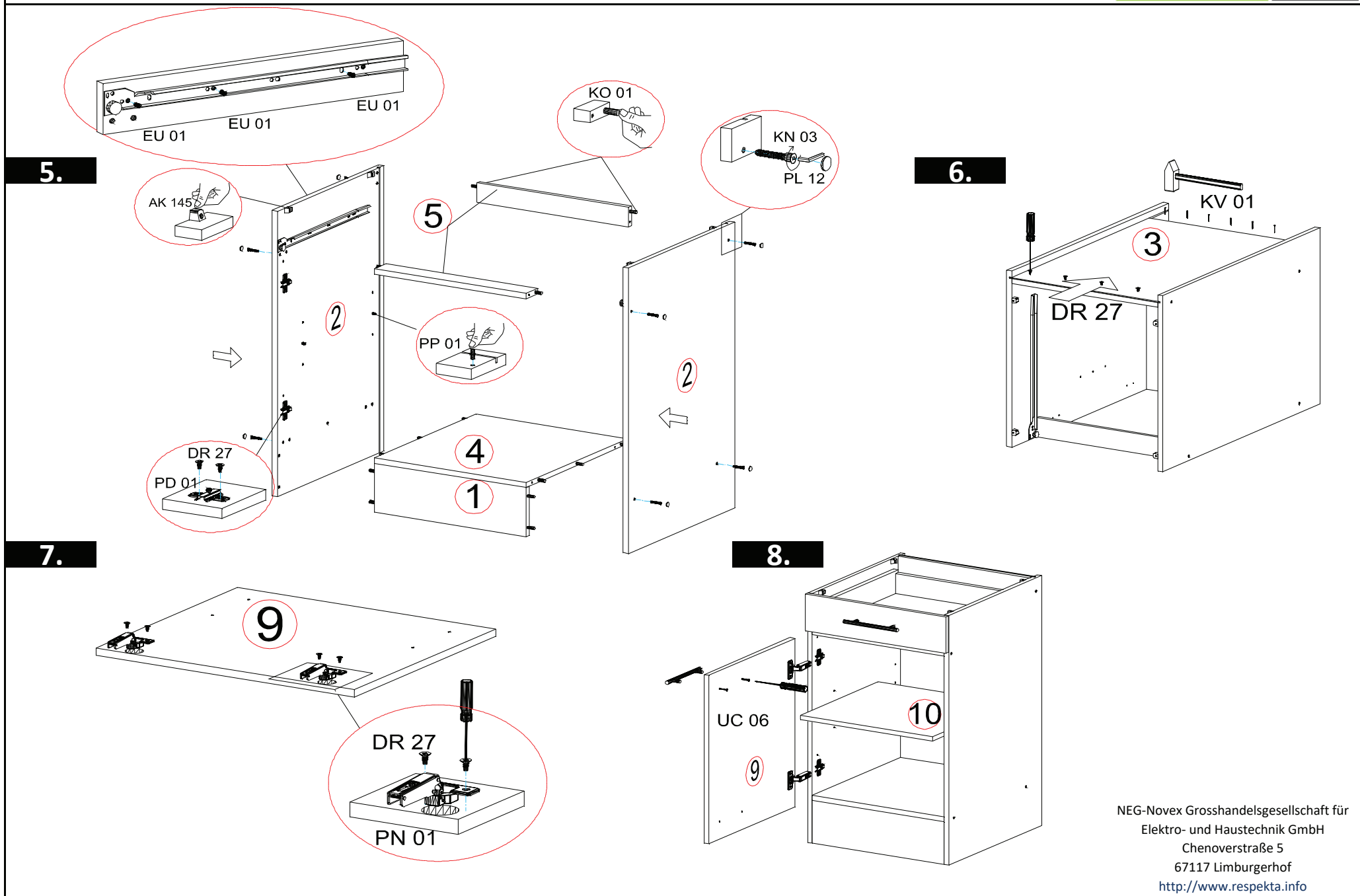

KB270KEY2 Unterschrank mit Blende Seite 7 von 8

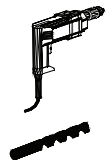
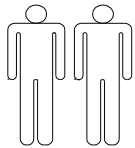

Ø5

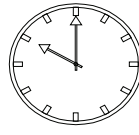
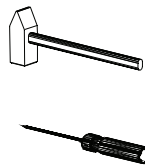

45min

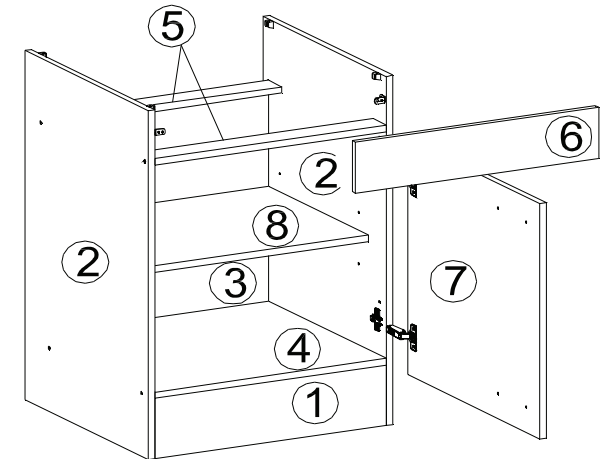
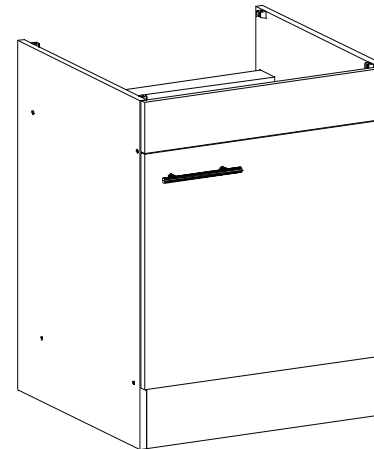

| | | |
|------------------------------|--------------------------------|---------------------------------|
| KO 01 8*30 14x | KN 03 7*50 8x | PL 12 8x |
| PN 01 2x | PD 01 2x | DR 27 3,5*16 12x |
| DR 42 4*30 4x | KV 01 1,5*20 10x | PL 01 1x |
| KL 01 4mm 1x | UC 06 2x | UC 10 (128 mm) 1x |
| AK 121 2x | AK 145 4x | PP 01 4x |
| SP 01 2x | | |

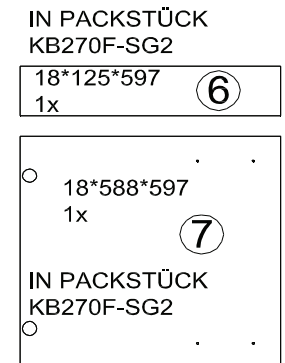
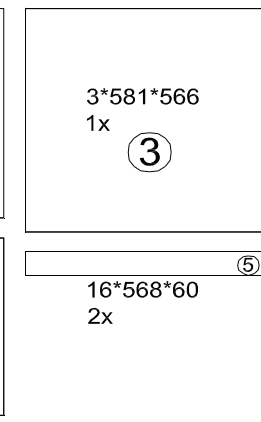
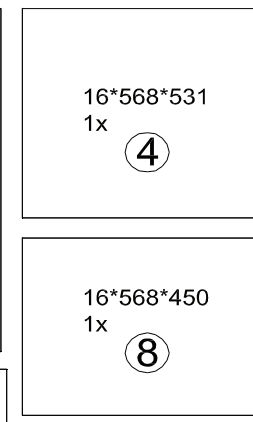
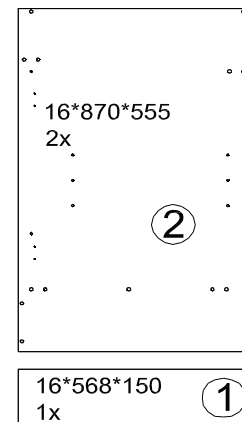

Zum Schutz der Holzteile können Sie rundum die Sockelleiste eine Silikonnaht ziehen.

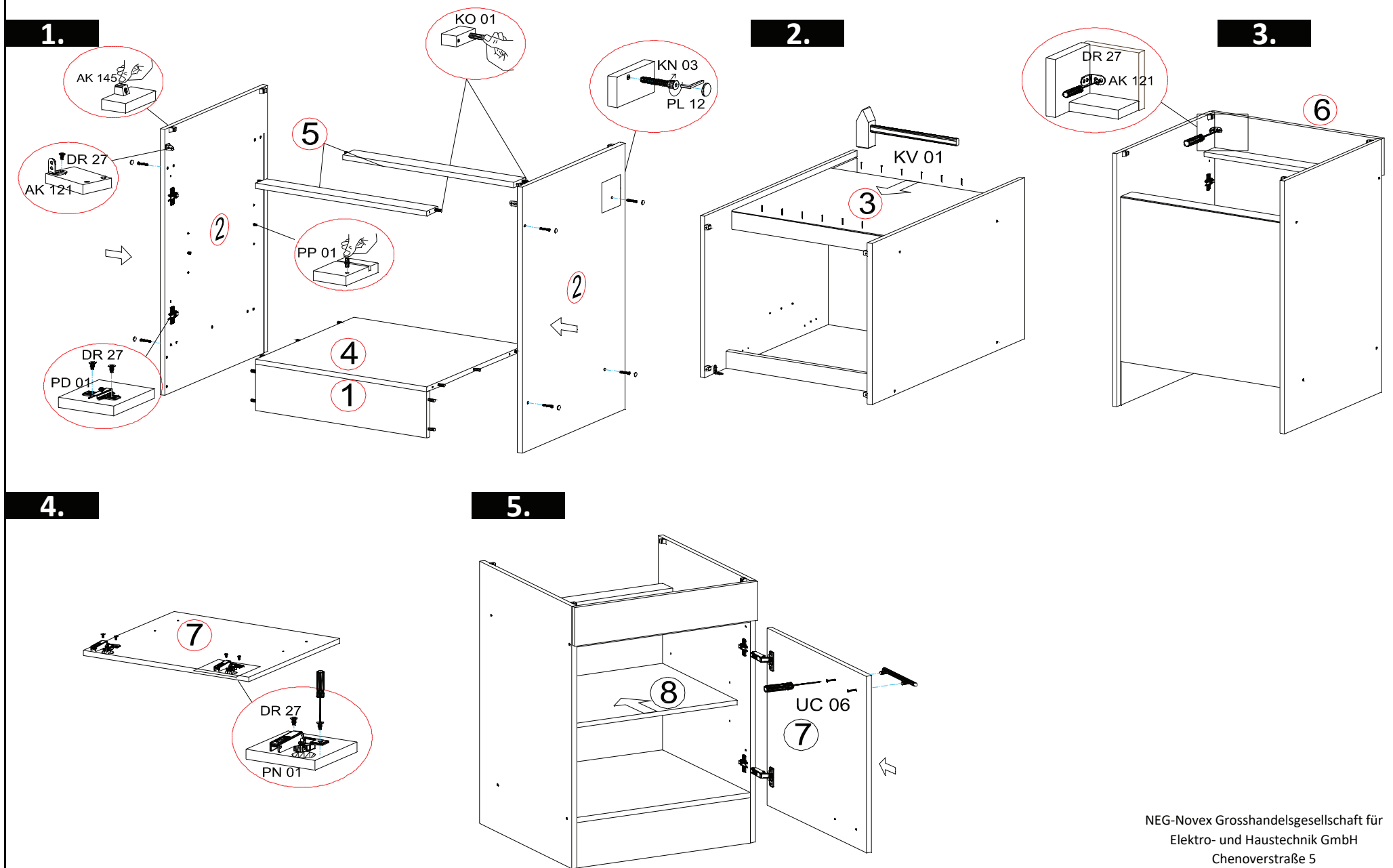

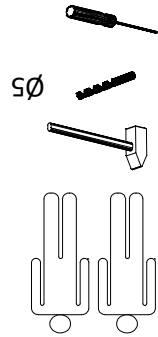

Ø5

Mit Ø5 Bohrer
durchbohren



SP01
4x



DR 42 4*30
12x

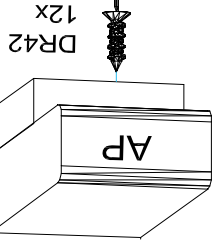
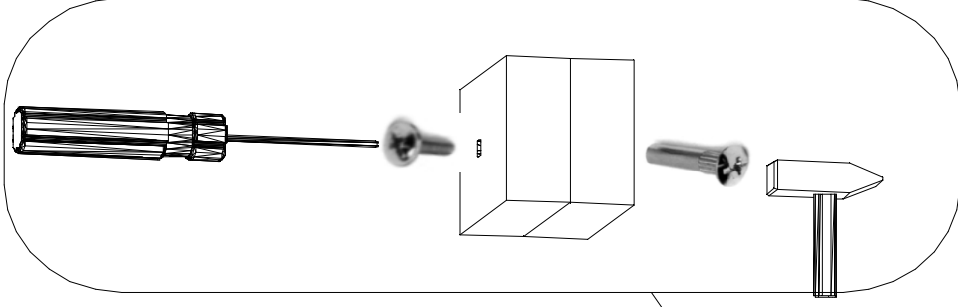
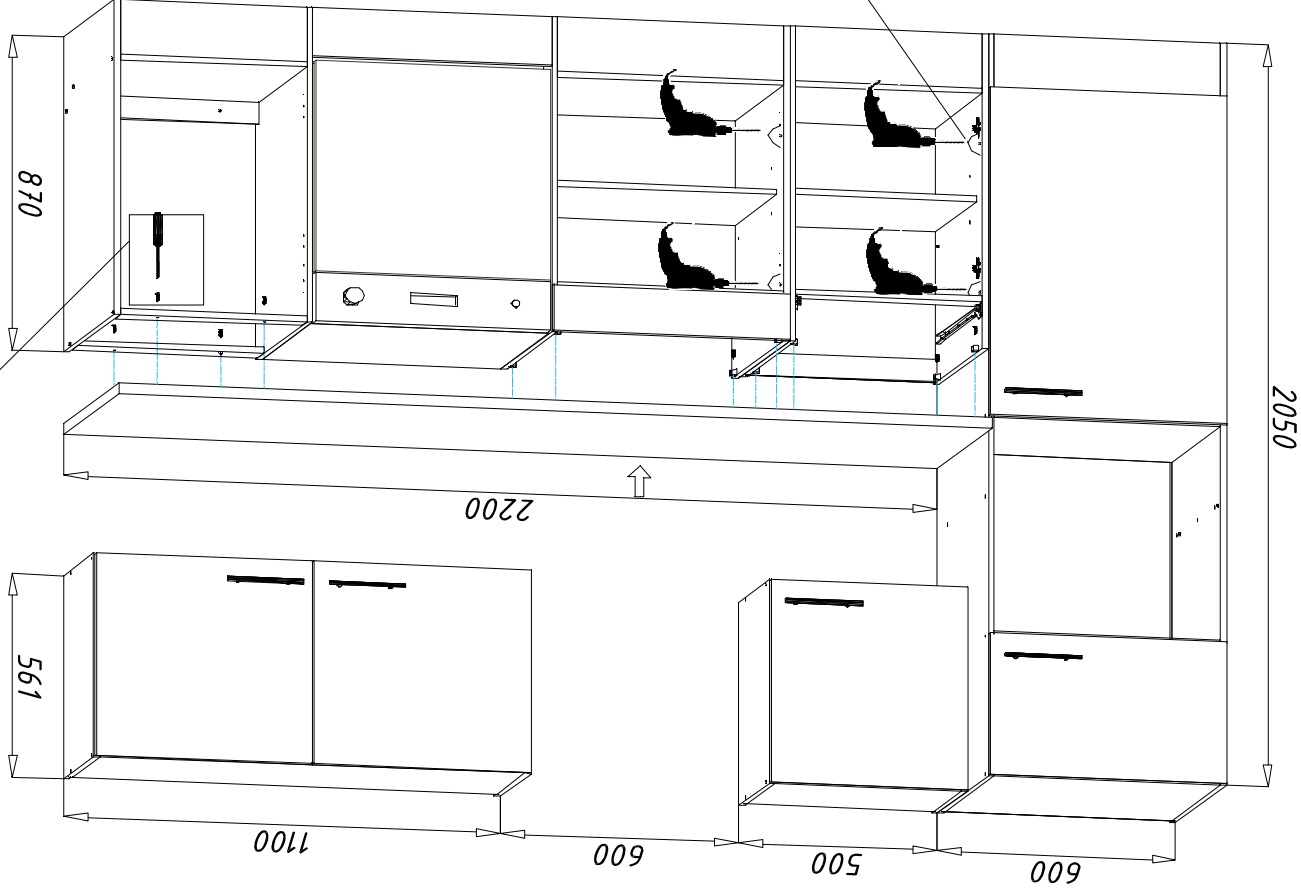

DR42
12x



KB280KEY (B)

respekta®
Kitchen Economy

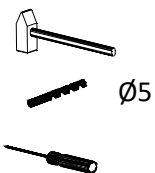
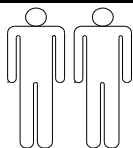

Mit Ø5 Bohrer
durchbohren



SP01
4x



DR 42 4*30
12x

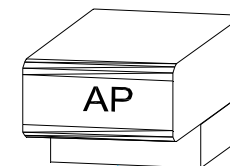
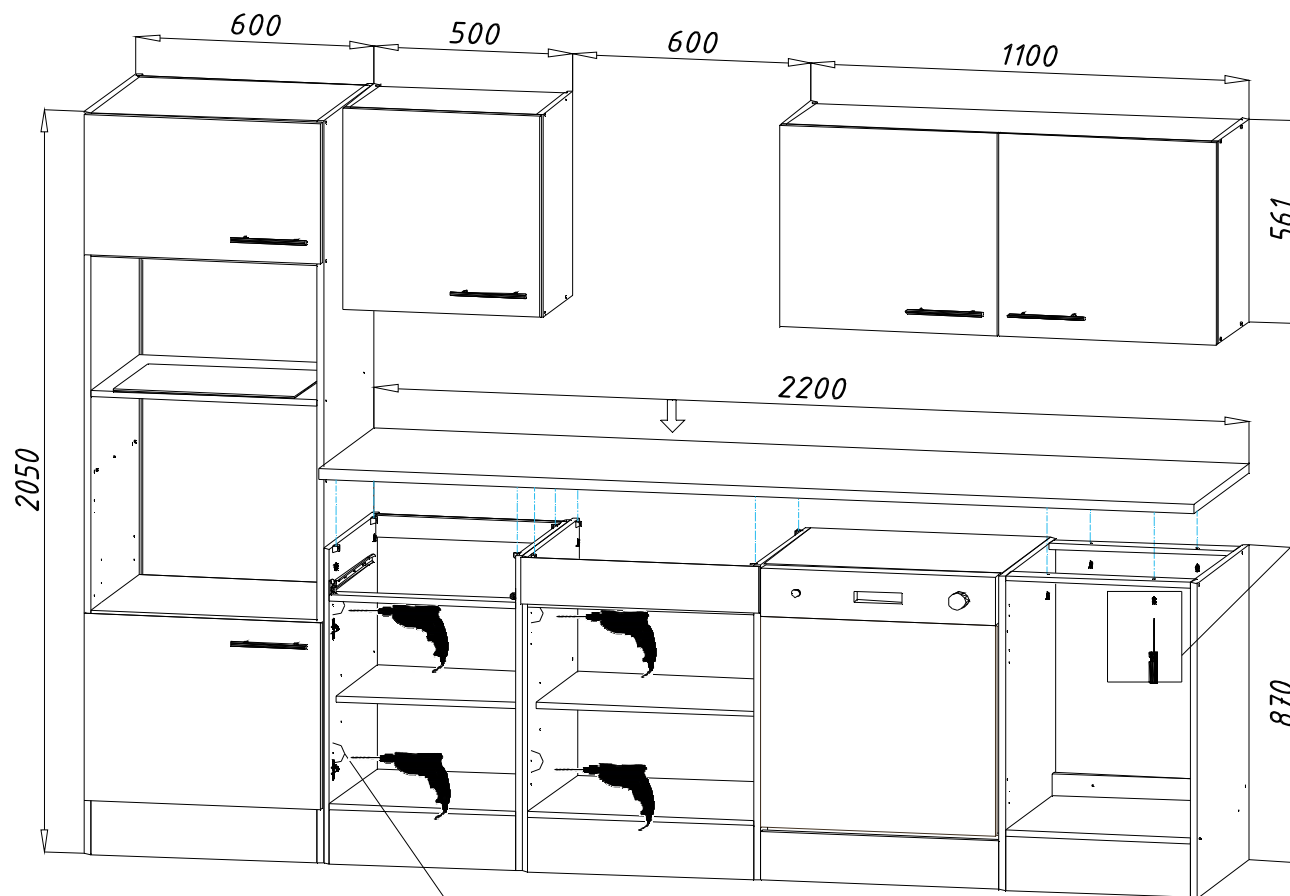

DR42
12x

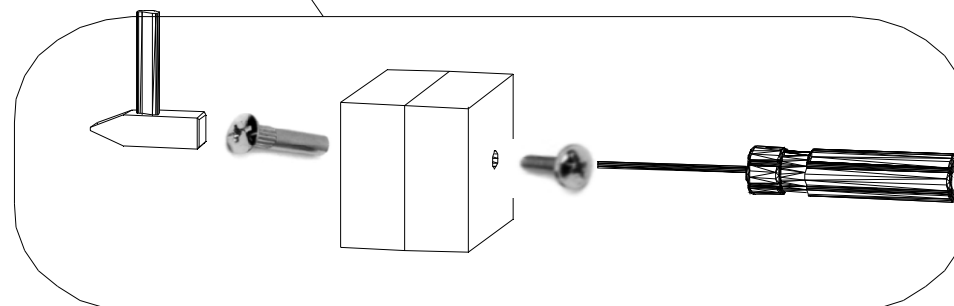

NEG-Novex Grosshandelsgesellschaft für
Elektro- und Haustechnik GmbH
Chenoverstraße 5
67117 Limburgerhof
<http://www.respekta.info>

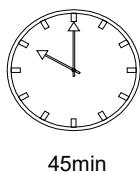
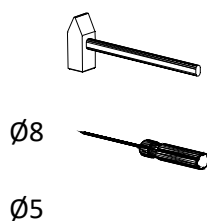
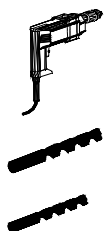
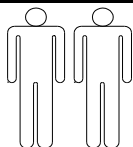

45min

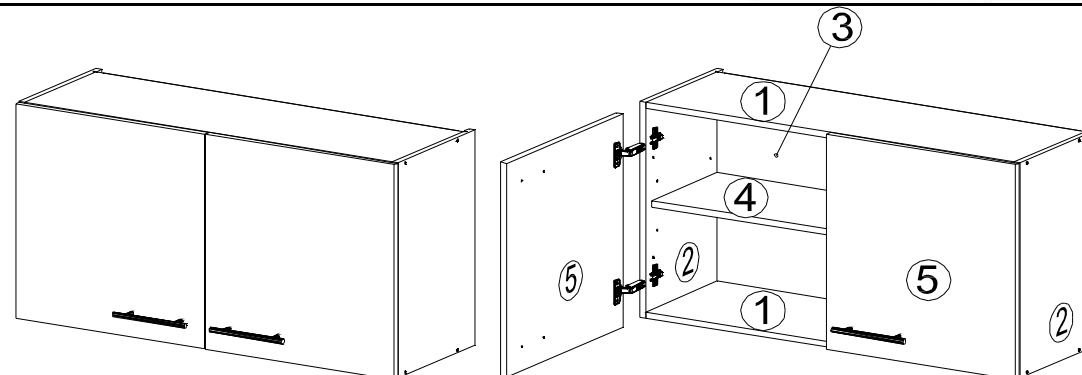
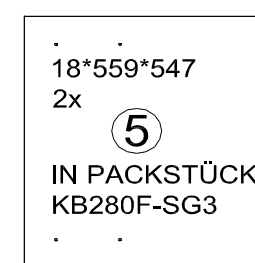
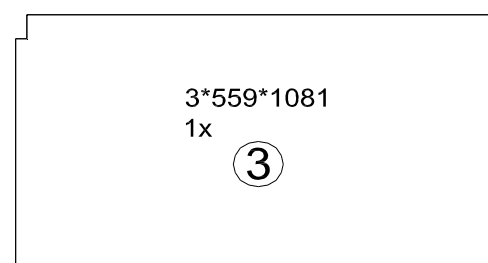
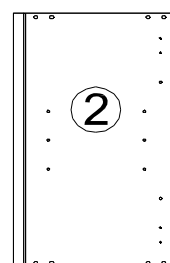
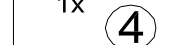
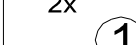

 16*561*330
 2x

 16*1068*280
 1x

 16*1068*306
 2x

| | | |
|-------------------------|--------------------------|----------------------|
| KO 01 8*30 8x | KN 03 7*50 8x | PL 12 8x |
| PP 01 4x | PN 01 4x | PD 01 4x |
| AK 103 2x | DR 27 3,5*16 16x | DR 42 4*30 4x |
| KV 01 1,5*20 20x | PL 16 2x | HK 01 2x |
| PL 01 1x | UC 10 (128 mm) 2x | UC 06 4x |
| KL 01 4mm 1x | SP 01 2x | |

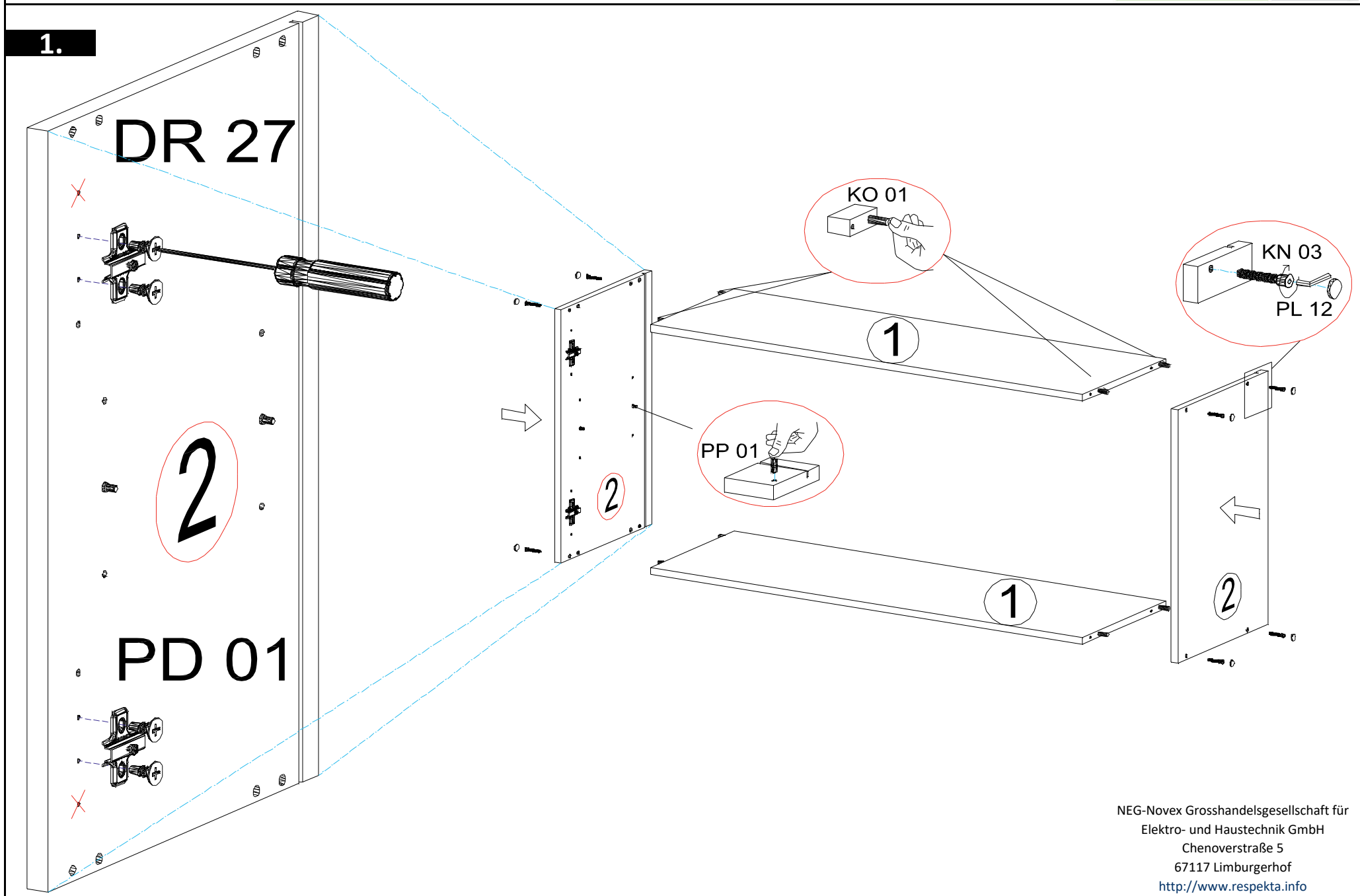
DE Eine unsachgemäße Befestigung der Hängebeschläge / Wandbefestigung kann zur Ablösung der Hängeschränke aus der Wand führen.

Benutzen Sie unbedingt Dübel, den in Verbindung mit dem Wandmaterial die Tragfähigkeit sicherstellen.

Sollten Sie unsicher sein welchen Typ Dübel und Schrauben Sie benötigen, fragen Sie bitte beim Fachhandel nach.



2.

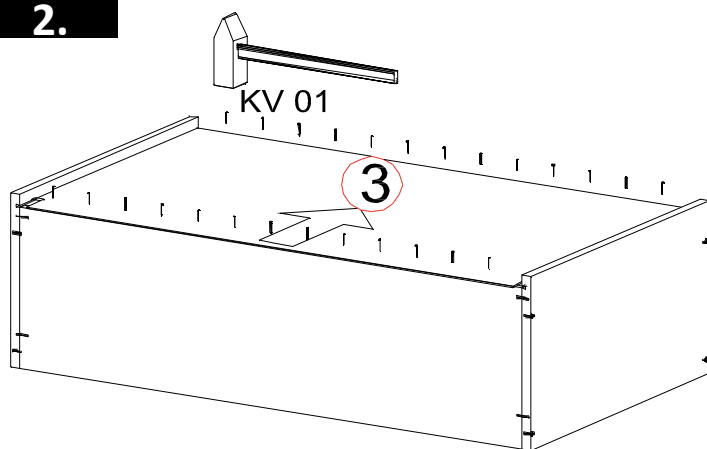

3.

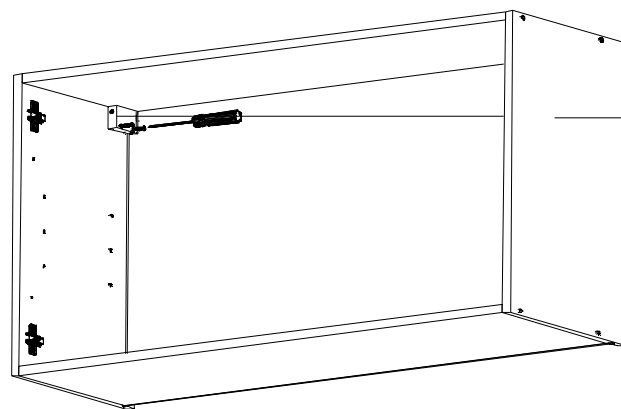

AK 103

DR 42

B > 40mm

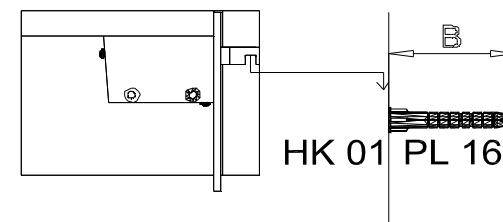

HK 01 PL 16

4.

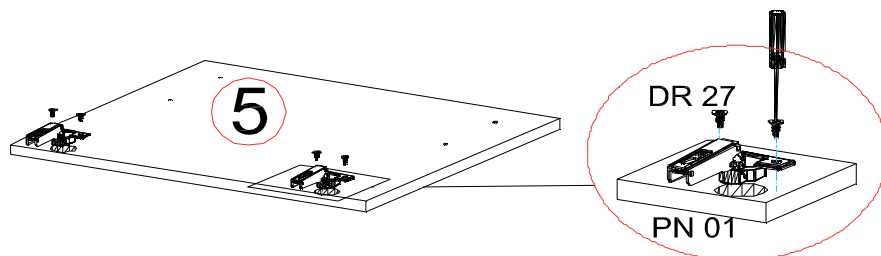

DR 27

PN 01

5.

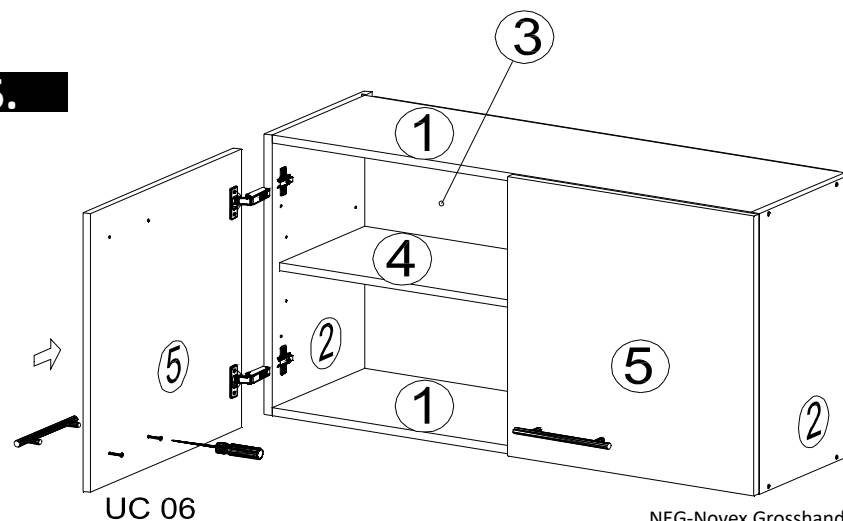

UC 06

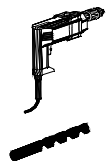
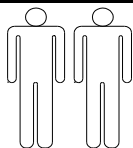

Ø5

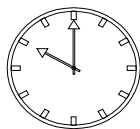
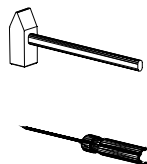

30min

 KO 01 8*30
 16x

 KN 03 7*50
 10x

 PL 12
 10x

 PN 01
 2x

 PD 01
 2x

 PL 01
 1x

 DR 27 3,5*16
 8x

 DR 42 4*30
 4x

 KL 01 4mm
 1x

 UC 06
 2x

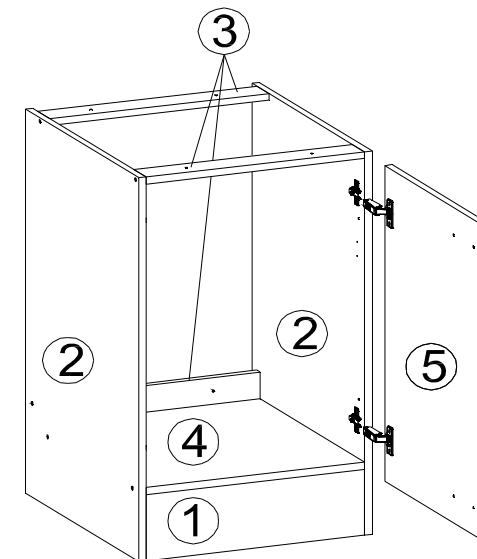
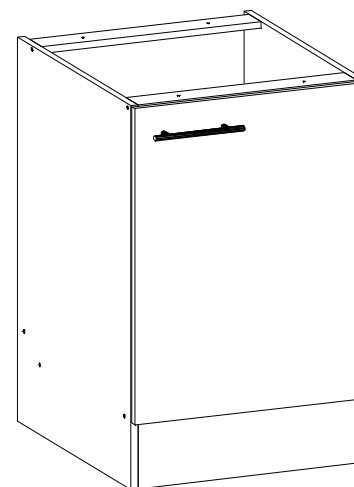
 UC 10 (128 mm)
 1x

 16*870*555
 2x

②

 16*468*531
 1x

④

 18*716*497
 1x

⑤

 IN PACKSTÜCK
 KB280F-SG3

 16*468*60
 3x

③

 16*468*150
 1x

①

 Zum Schutz der Holzteile können Sie rundum die
 Sockelleiste eine Silikonnaht ziehen.

 NEG-Novex Grosshandelsgesellschaft für
 Elektro- und Haustechnik GmbH
 Chenoverstraße 5
 67117 Limburgerhof
<http://www.respekta.info>

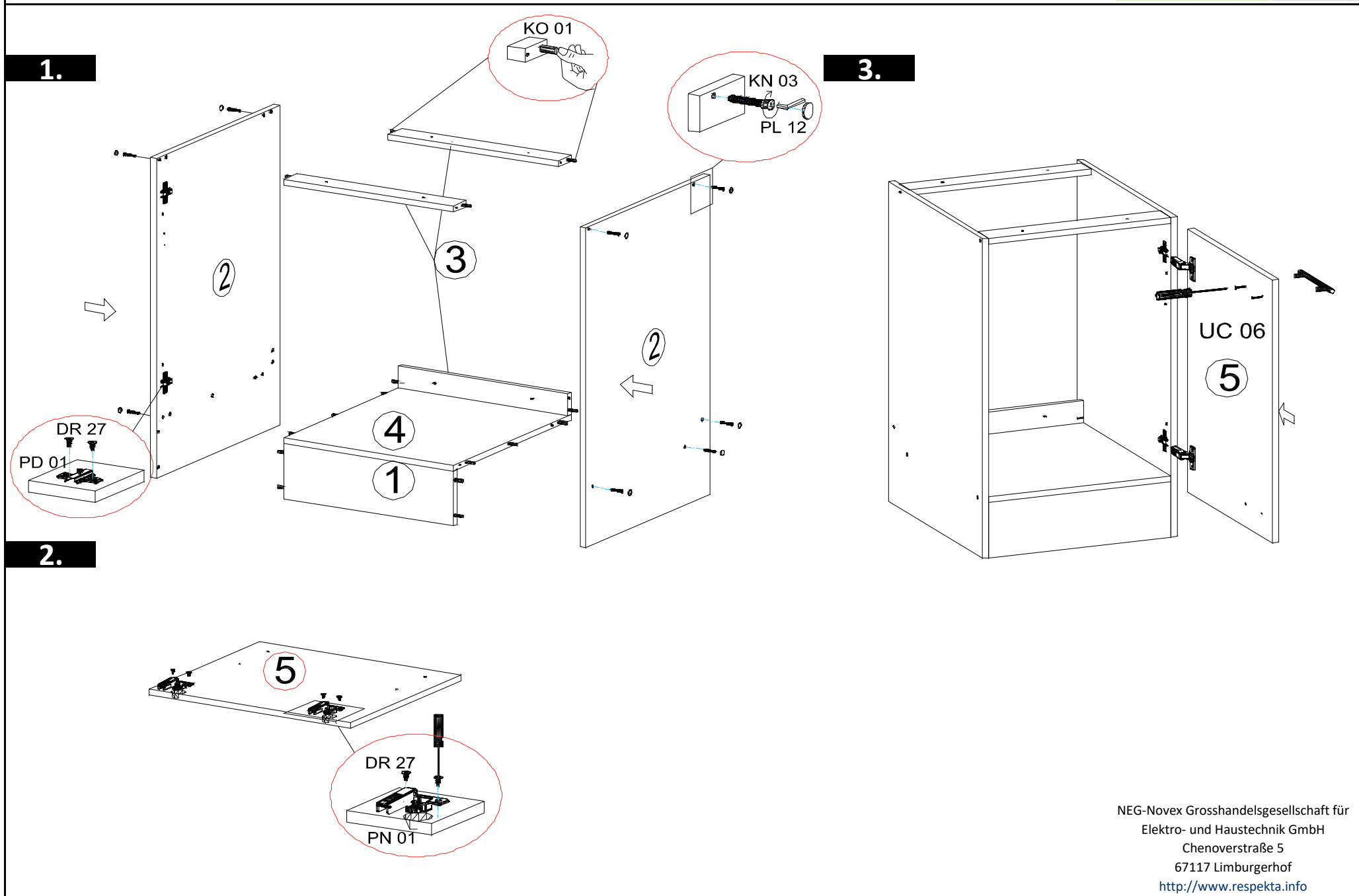

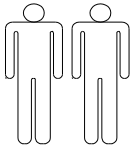

DR 27 3,5*16
8x



MZ 01
2x



MZ 02
2x



16*600*136
1x



16*580*592
1x

②

GSP FRONT
IN PACKSTÜCK
7.

1.

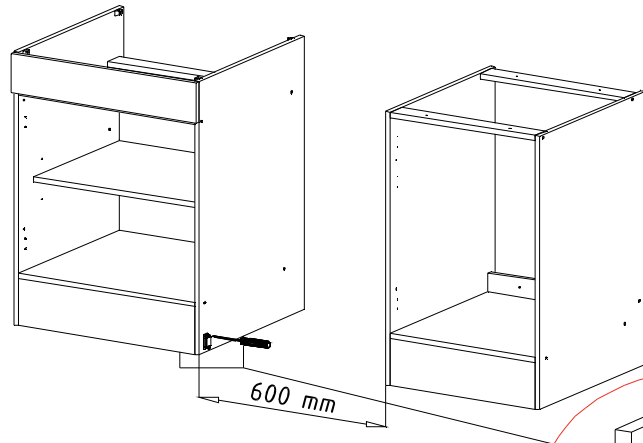

2.

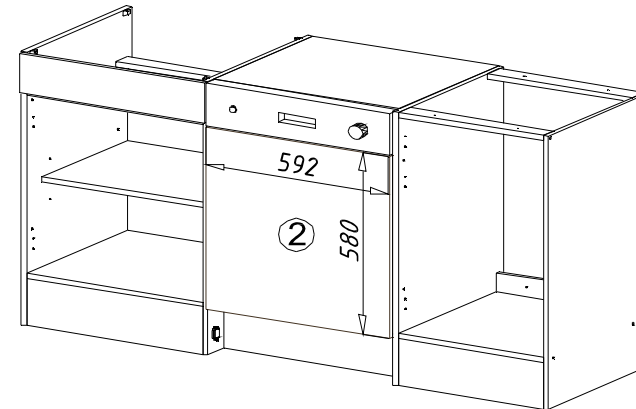

3.

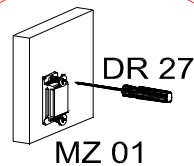
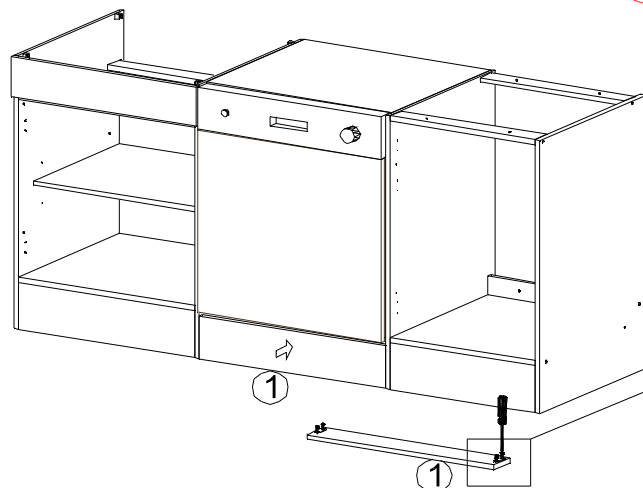

**Den Aufbau vom Front sehen Sie in
der Bedienungsanleitung vom
Geschirrspüler!!**

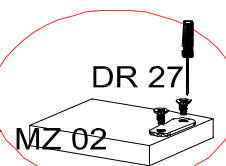

1. Modell

2. Modell

3. Modell

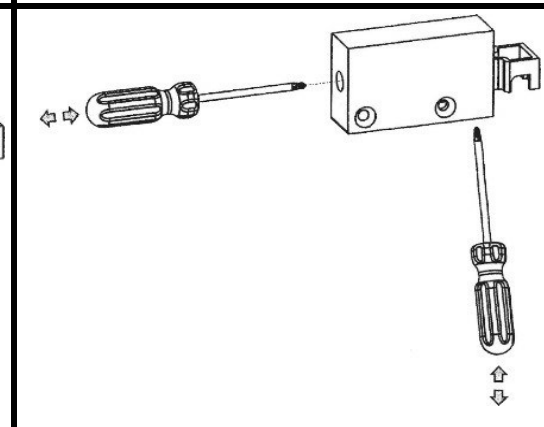
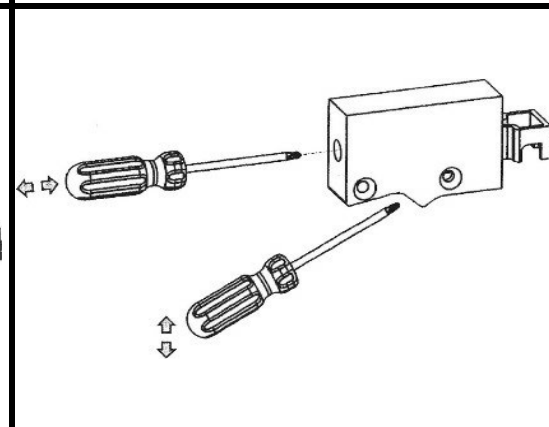
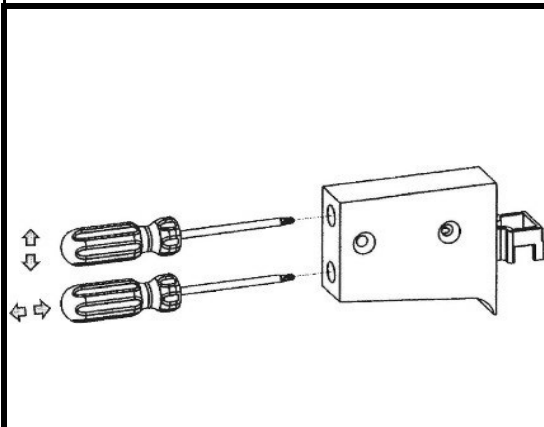

**ACHTUNG!!!
ATTENTION!!!**

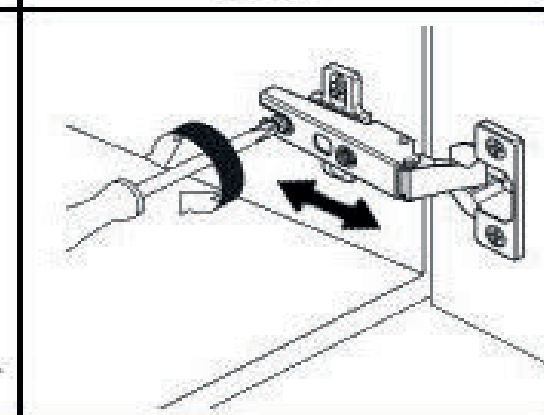
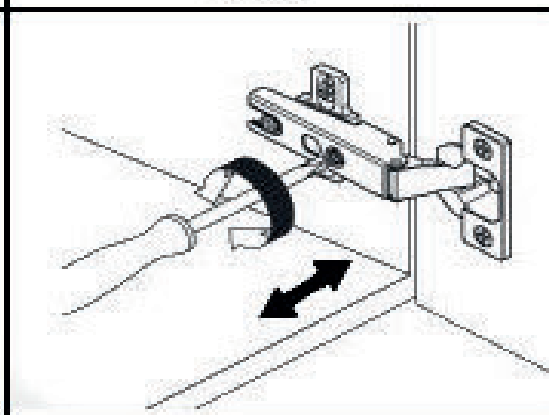
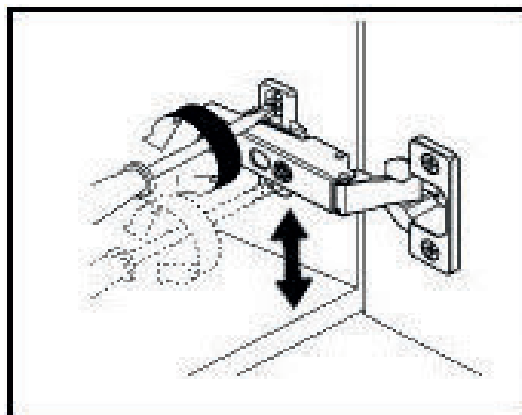
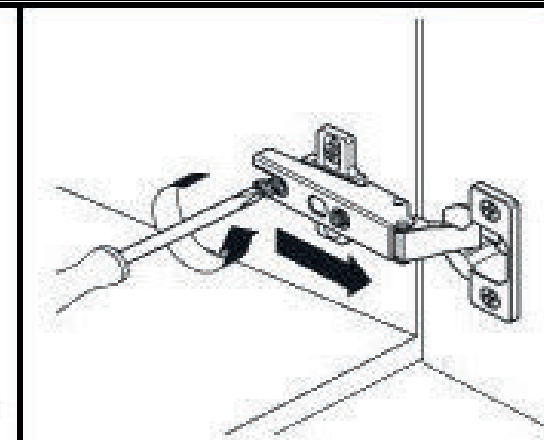
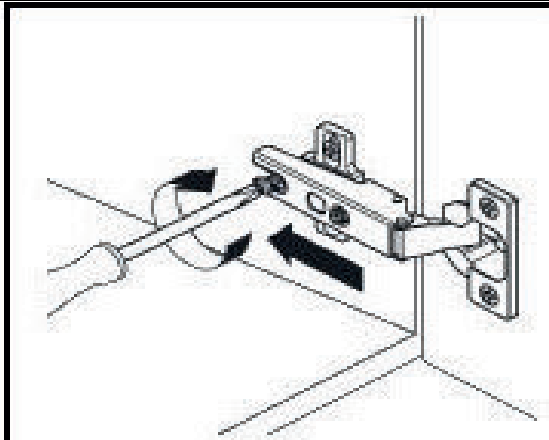
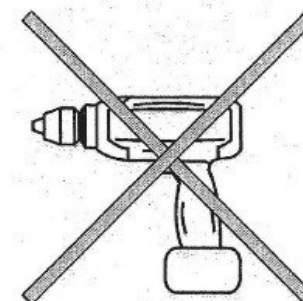
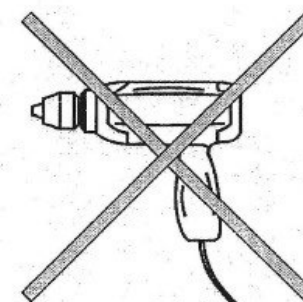

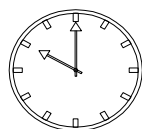
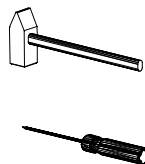
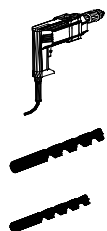
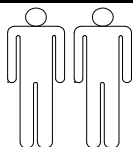

30min

Ø8

Ø5

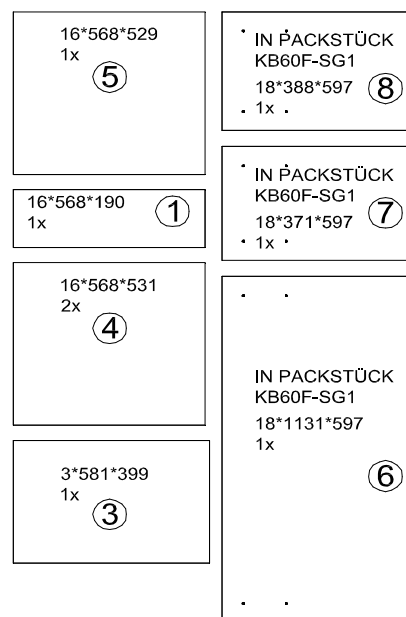
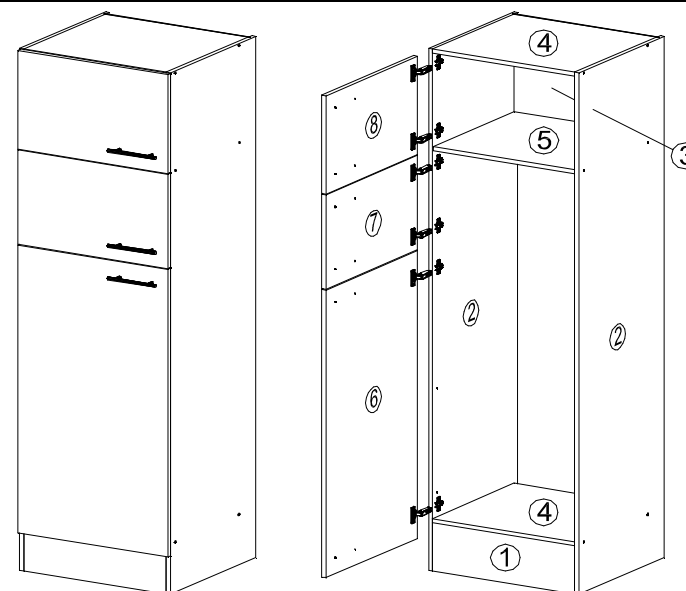
KO 01 8*30
22xKN 03 7*50
12xPL 12
12xPN 01
6xPD 01
6xDR 27 3,5*16
24xSP 01
2xKV 01 1,5*20
10xPL 01
1xKL 01 4mm
1xUC 06
6xUC 10 (128 mm)
3x

NEG-Novex Grosshandelsgesellschaft für
Elektro- und Haustechnik GmbH
Chenoverstraße 5
67117 Limburgerhof
<http://www.respekta.info>

Zum Schutz der Holzteile können Sie rundum die
Sockelleiste eine Silikonnaht ziehen.



